

Workholding cubes, grey cast iron

with pre-machined clamping faces



Material:
GJL 300.

Version:
Support and clamping faces are precision-machined.
The clamping faces have a +0.5 mm allowance.

Sample order:
nlm 01850-100030050

Note:
Workholding cubes with pre-machined clamping faces provide a quick and economic way of producing base elements with specific grid or individual holes. The foot is ready for mounting on the machine table. The four clamping faces can be machined to the end dimensions by the user. The workholding cubes conform to machine tables for machine tools acc. to DIN 55201 and JIS 6337-1980.
Please order locating pins for positioning subplates on machine tables acc. to DIN 55201 separately.
Ring bolts for hoisting are supplied.
Other dimensions available on request.

Drawing reference:
1) hole for DIN 912 cap screw (D3/D4)

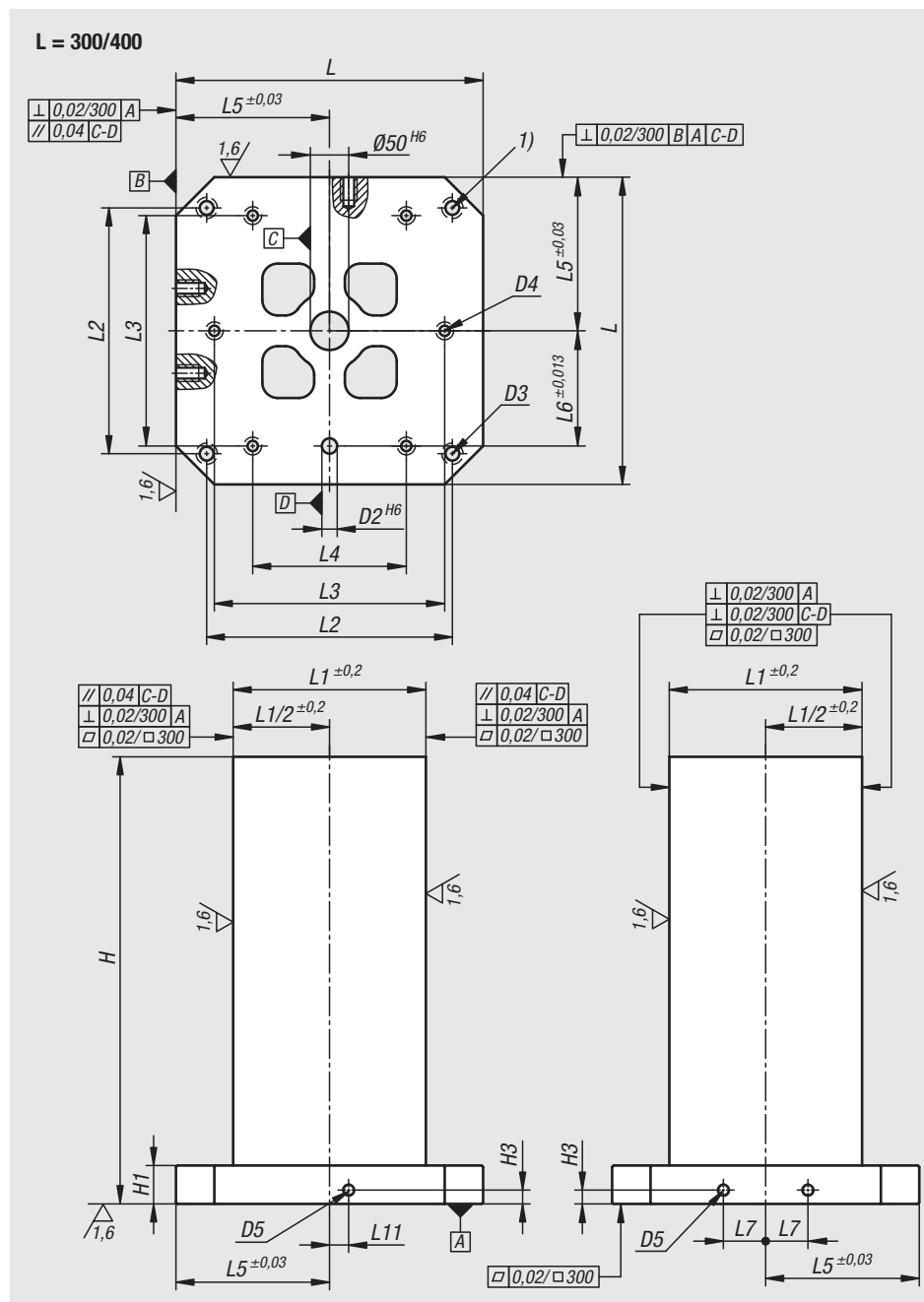

Order No.	L	H	H1	D2	D3	D4	D5	H3	L1	L2	L3	L4	L5	L6	L7	L11
01850-100030050	300	500	50	20	M12	M10	M12	15	151	250	200	-	150	100	40	0
01850-100040050	400	500	50	20	M16	M12	M16	18	251	320	300	200	200	150	55	25
01850-100040065	400	650	50	20	M16	M12	M16	18	251	320	300	200	200	150	55	25
01850-100050060	500	600	50	20	M16	M12	M16	18	301	400	200	-	250	200	75	25
01850-100050075	500	750	50	20	M16	M12	M16	18	301	400	200	-	250	200	75	25
01850-100063070	630	700	50	25	M16	M16	M16	18	351	500	400	-	315	200	100	25
01850-100063085	630	850	50	25	M16	M16	M16	18	351	500	400	-	315	200	100	25
01850-100080080	800	800	50	25	M16	M16	M16	18	501	640	600	400	400	300	135	25
01850-100080100	800	1000	50	25	M16	M16	M16	18	501	640	600	400	400	300	135	25
01850-100100100	1000	1000	55	25	M20	M20	M16	18	601	800	200	-	500	400	165	25
01850-100100125	1000	1250	55	25	M20	M20	M16	18	601	800	200	-	500	400	165	25

Workholding cubes, grey cast iron

with pre-machined clamping faces

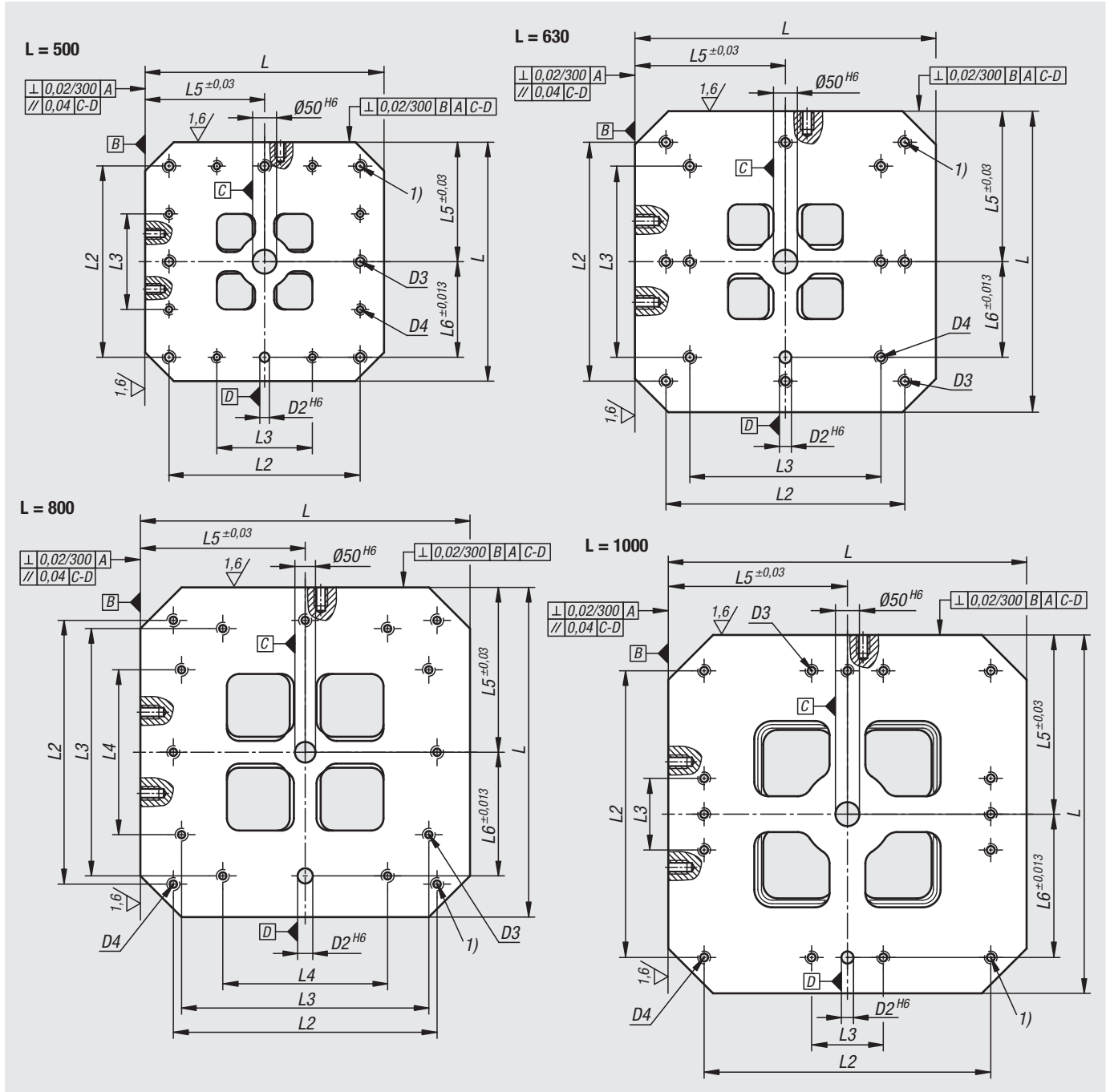

01000
02000
03000
04000
05000
06000
07000
08000
09000
10000
12000

Workholding cubes, grey cast iron

with T-slots



Material:
GJL 300.

Version:
Support and mounting surfaces precision machined

Sample order:
nlm 01850-314040050

Note:
Workholding cubes with T-slots are used for constructing modular fixtures on horizontal machines. The precise longitudinal and transverse slot spacing ensures very high repeat clamping accuracy. The workholding cubes conform to machine tables for machine tools acc. to DIN 55201 and JIS 6337-1980. Please order locating pins for positioning subplates on machine tables acc. to DIN 55201 separately. Ring bolts for hoisting are supplied. Other dimensions available on request.

Drawing reference:

1) hole for DIN 912 cap screw (D3/D4)

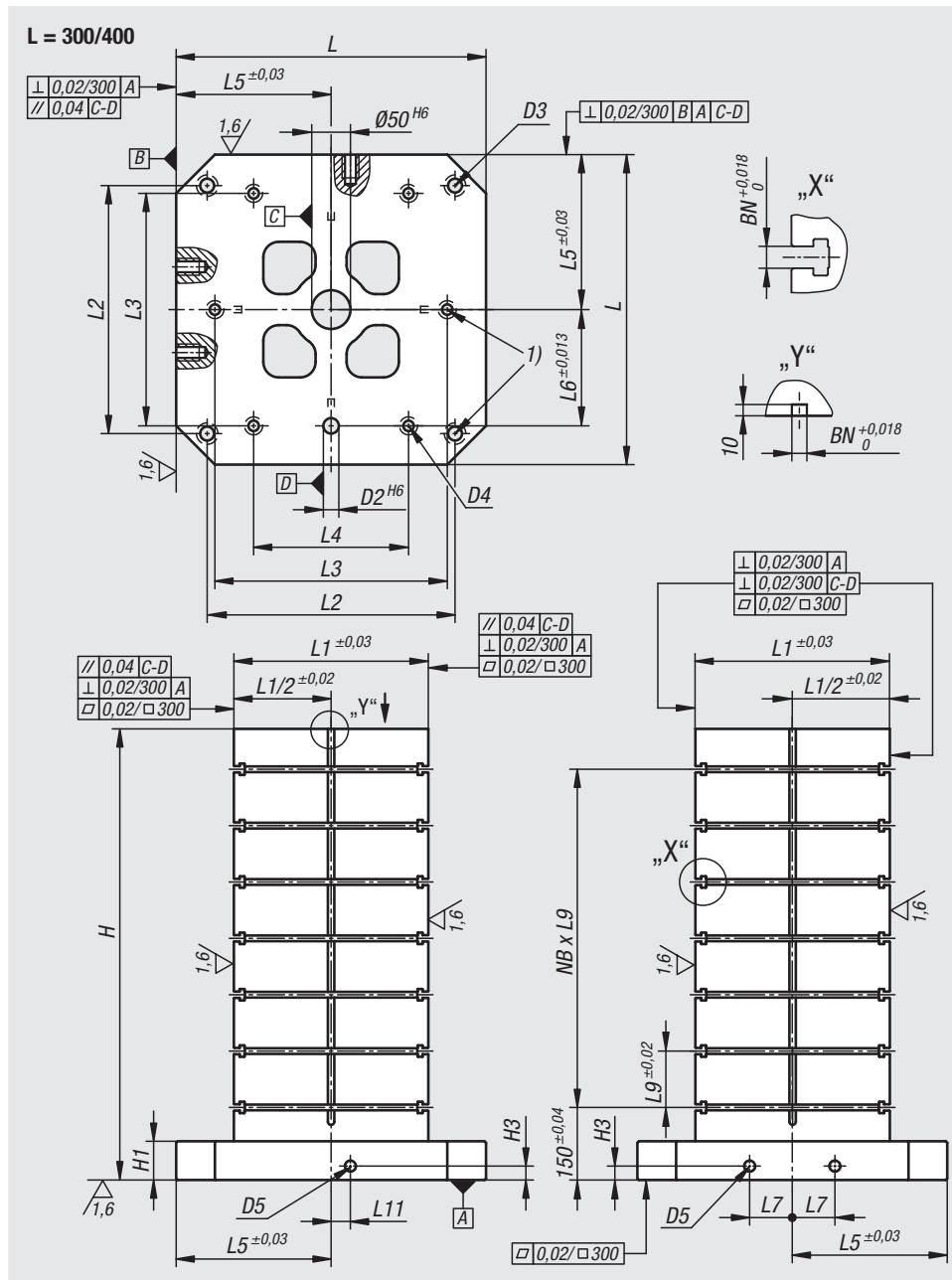

Order No. BN=Slot width 14	Order No. BN=Slot width 18	L	H	H1	D2	D3	D4	D5	H3	L1	L2	L3	L4	L5	L6	L7	L9	L11	NB= No. across
01850-314040050	01850-318040050	400	500	50	20	M16	M12	M16	18	250	320	300	200	200	150	55	100	25	3
01850-314040065	01850-318040065	400	650	50	20	M16	M12	M16	18	250	320	300	200	200	150	55	100	25	4
01850-314050060	01850-318050060	500	600	50	20	M16	M12	M16	18	300	400	200	-	250	200	75	100	25	4
01850-314050075	01850-318050075	500	750	50	20	M16	M12	M16	18	300	400	200	-	250	200	75	100	25	5
01850-314063070	01850-318063070	630	700	50	25	M16	M16	M16	18	350	500	400	-	315	200	100	125	25	4
01850-314063085	01850-318063085	630	850	50	25	M16	M16	M16	18	350	500	400	-	315	200	100	125	25	5
01850-314080080	01850-318080080	800	800	50	25	M16	M16	M16	18	500	640	600	400	400	300	135	150	25	4
01850-314080100	01850-318080100	800	1000	50	25	M16	M16	M16	18	500	640	600	400	400	300	135	150	25	5
01850-314100100	01850-318100100	1000	1000	55	25	M20	M20	M16	18	600	800	200	-	500	400	165	160	25	5
01850-314100125	01850-318100125	1000	1250	55	25	M20	M20	M16	18	600	800	200	-	500	400	165	160	25	6

Workholding cubes, grey cast iron

with T-slots

