

V-block machined all sides

grey cast iron or aluminium



Material:
GJL 250 annealed or EN AW-7075.

Sample order:
nlm 01640-05X200
(include length L)

Note:
The length L is cut by saw and is always supplied overlong.

Drawing reference:
machined faces: ± 0.25 mm
length tolerance:
 ≤ 200 mm: $+3/+10$
 > 200 mm ≤ 590 mm: $+8/+15$
 ≥ 600 mm: $+20/+50$

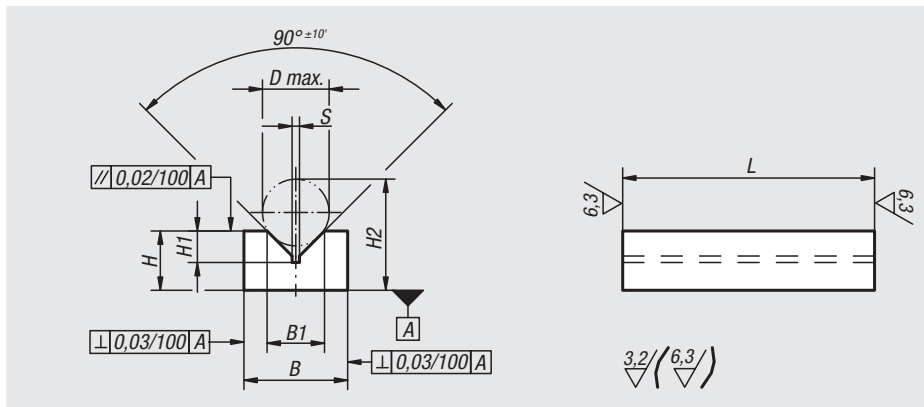

Order No. grey cast iron	Order No. aluminium	L = length	B	B1	H	H1	H2	D max.	S
01640-01X	01640-201X	100/200	25	15,5	16	8,5	30	18	2
01640-02X	01640-202X	100/200	36	21,9	20	11	38	24	2
01640-03X	01640-203X	100/200	40	26	25	13,5	47	29	2,5
01640-04X	01640-204X	200/300/600	50	31,7	36	17	66	38	2,5
01640-05X	01640-205X	200/300/600	70	50	50	26	95	58	3
01640-06X	01640-206X	200/300/600	100	79,3	70	41	139	90	4

V-block machined all sides

extra wide, grey cast iron



Material:
GJL 250 annealed.

Sample order:
nlm 01660-04X00
(include length L)

Note:
The length L is cut by saw and is always supplied overlong.

Drawing reference:
machined faces: ± 0.25 mm
length tolerance:
 ≤ 200 mm: $+3/+10$
 > 200 mm ≤ 590 mm: $+8/+15$
 ≥ 600 mm: $+20/+50$

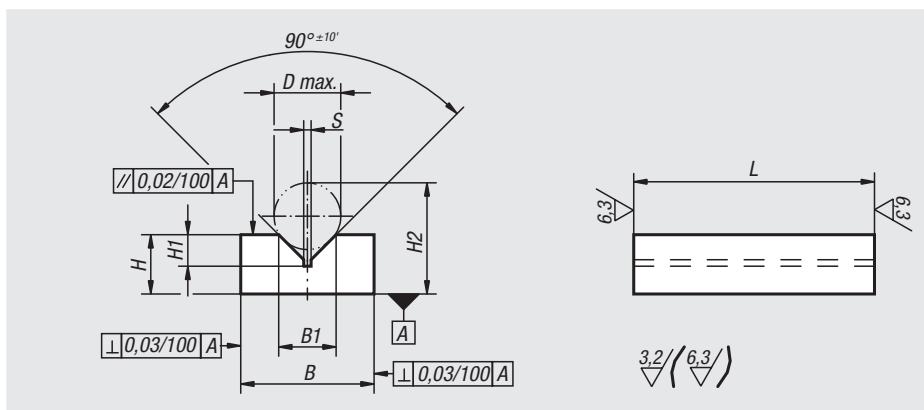

Order No.	L = length	B	B1	H	H1	H2	D max.	S
01660-01X	100/200	36	15,5	16	8,5	30	18	2
01660-02X	100/200	50	21,9	25	11	43	24	2
01660-03X	100/200	63	26	32	13,5	54	29	2,5
01660-04X	200/300/600	100	31,7	40	17	70	38	2,5
01660-05X	200/300/600	125	50	56	26	101	58	3
01660-06X	200/300/600	160	79,3	80	41	149	90	4