

L-profiles unequal

grey cast iron or aluminium



Material:

GJL 250 annealed or EN AW-7075.

Sample order:

nIm 01440-03X600
(include length L)

Note:

The length L is cut by saw and is always supplied overlong.

Drawing reference:

machined faces: ± 0.25 mm

length tolerance:

≤ 200 mm: $+3/+10$

> 200 mm ≤ 590 mm: $+8/+15$

≥ 600 mm: $+20/+50$

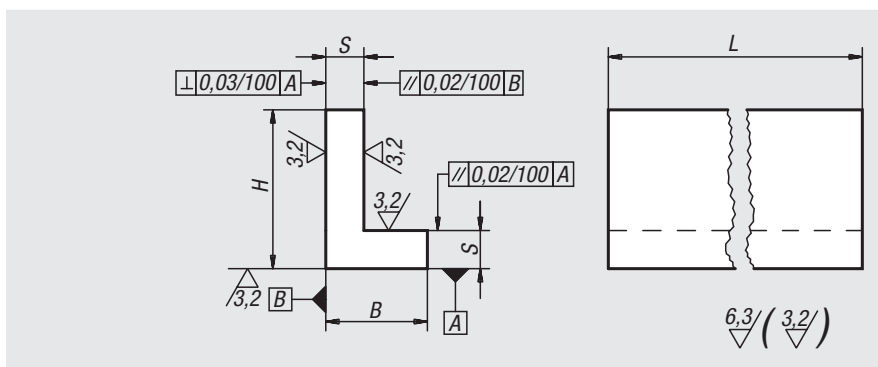

Order No. grey cast iron	Order No. aluminium	L = length	B	H	S
01440-01X	01440-201X	150/300	32	50	12
01440-02X	01440-202X	150/300	40	63	12
01440-03X	01440-203X	200/300/600/800	63	80	16
01440-04X	01440-204X	200/300/600/1000	80	100	20
01440-05X	01440-205X	200/300/600/1000	100	125	20
01440-06X	01440-206X	200/300/600	125	160	25
01440-07X	01440-207X	200/300/600	160	200	32
01440-08X	01440-208X	300/600	200	250	36
01440-09X	-	300/600	250	315	36

L profile with reinforcing ribs

grey cast iron



Material:

GJL 250 annealed.

Sample order:

nIm 01520-04X400
(include length L)

Note:

Angle plates with lengths 150 mm and 200 mm have only one reinforcing rib.

The length L is cut by saw and is always supplied overlong.

Drawing reference:

machined faces: ± 0.25 mm

unmachined faces: ± 2 mm

length tolerance:

≤ 200 mm: $+2/+5$

> 200 mm: $+10/+20$

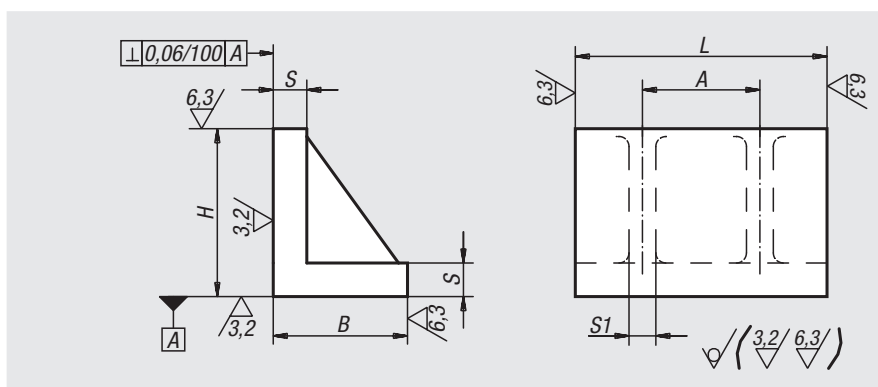

Order No.	L = length	B	H	S	S1	A
01520-01X	150/300	80	100	20	16	160
01520-02X	150/300	100	125	22	18	160
01520-03X	150/300	125	160	25	20	160
01520-04X	200/400	160	200	32	22	200
01520-05X	200/400	200	250	36	25	200