

## Magnetic Pickup

### Item description/product images



### Description

**Version:**

Strong permanent magnet with flexible brass tube and black plastic grip. Surface chromed.

**Note:**

Pickup magnets are primarily used for removing or searching for steel parts in inaccessible places.

### Drawings

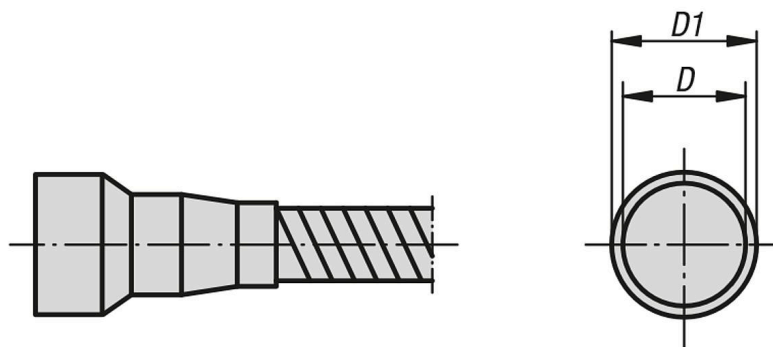

### Overview of items

#### Magnetic Pickup

Order No.	Size	D	D1	total length mm	Magnetic force N
K2498.01	1	6	8	450	5
K2498.02	2	10	12	450	10
K2498.03	3	13	15	520	18
K2498.04	4	17	19	520	30