

Workholding towers, grey cast iron, 4-sided with UNILOCK zero-point clamping system

Item description/product images

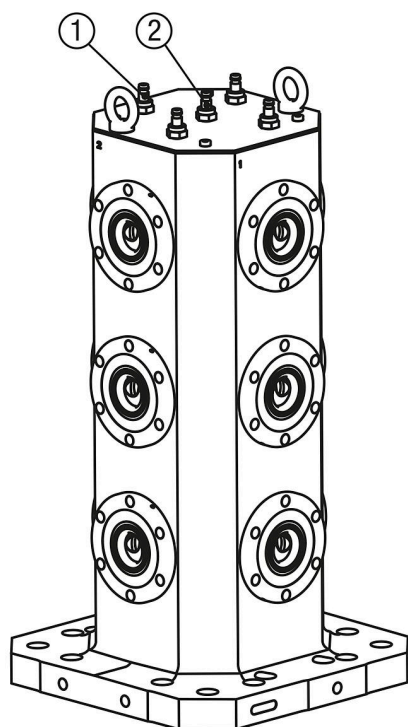
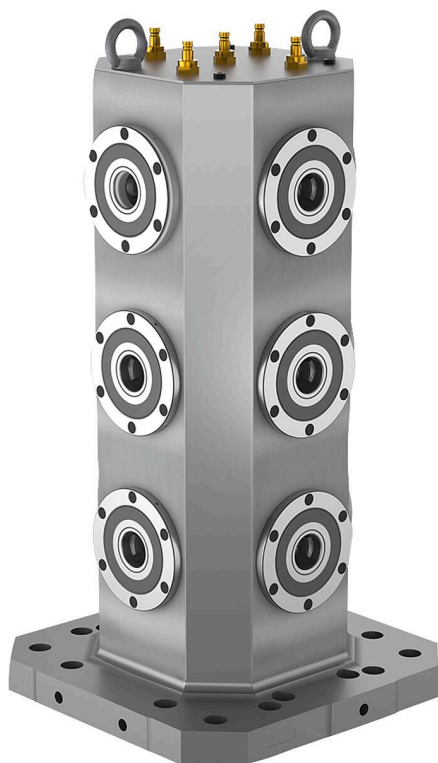

Description

Product description:

4-sided workholding tower with integrated UNILOCK clamping modules EFM 138. The integrated clamping modules enable the rapid clamping or exchange of clamping equipment and fixtures on the workholding tower. Set-up times are reduced and machine running times increased.

Material:

Workholding tower GJL 300.
Clamping module case-hardening steel.

Version:

Workholding tower contact faces precision machined.
Clamping module contact faces hardened and ground.

Note:

These 4-sided workholding towers conform to machine tables for machine tools acc. to DIN 55201 and JIS6337-1980.

The clamping modules are actuated via a central pneumatic connection. The high clamping forces are generated via the integrated spring package (the unit clamps while not under pressure). Clamping is released pneumatically.

The following clamping forces are possible with the UNILOCK clamping bolt in conjunction with M10, M12, M16 fastening screws:

- Clamping force (M10) 35,000 N/module
 - Clamping force (M12) 50,000 N/module
 - Clamping force (M16) 75,000 N/module
- Clamping force with DIN EN ISO 4762 -12.9 cap screws

Clamping bolts may only be clamped in conjunction with a mounted interchangeable unit in the clamping module.

Temperature range:

+5 °C to +60 °C.

Supplied with:

- Workholding tower
- Transport screws.
- Operating instructions.

Accessory:

- UNILOCK clamping bolts K0967.
- UNILOCK interchangeable subplates for zero-point clamping system K1218.
- UNILOCK protective bolts for clamping module K1010.
- UNILOCK protective plugs for clamping module K1010.

Drawing reference:

- 1) Open air port G1/8
- 2) Turbo function air port G1/8

Workholding towers, grey cast iron, 4-sided with UNILOCK zero-point clamping system

Drawings

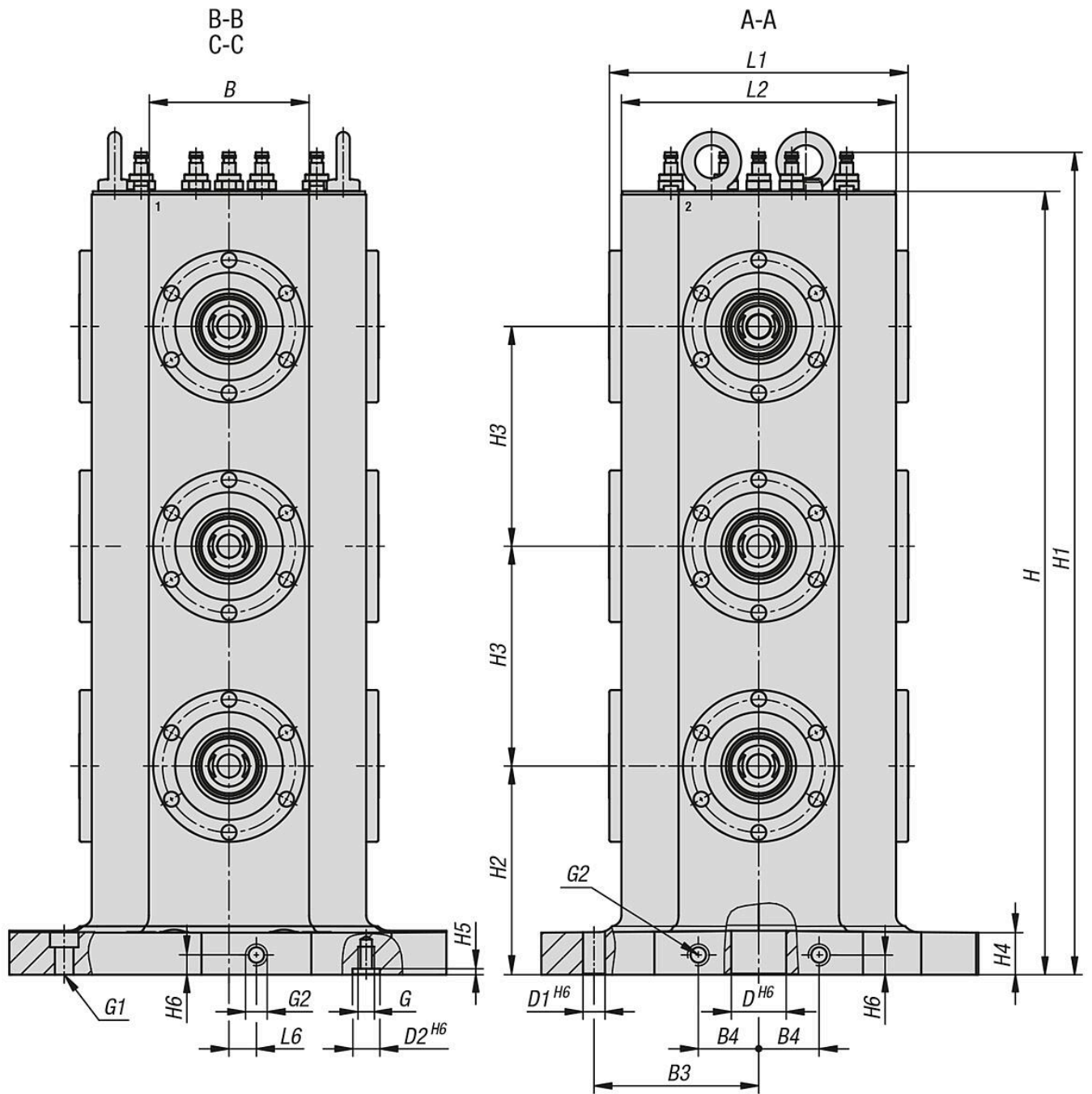

Workholding towers, grey cast iron, 4-sided with UNILOCK zero-point clamping system

Drawings

400x400

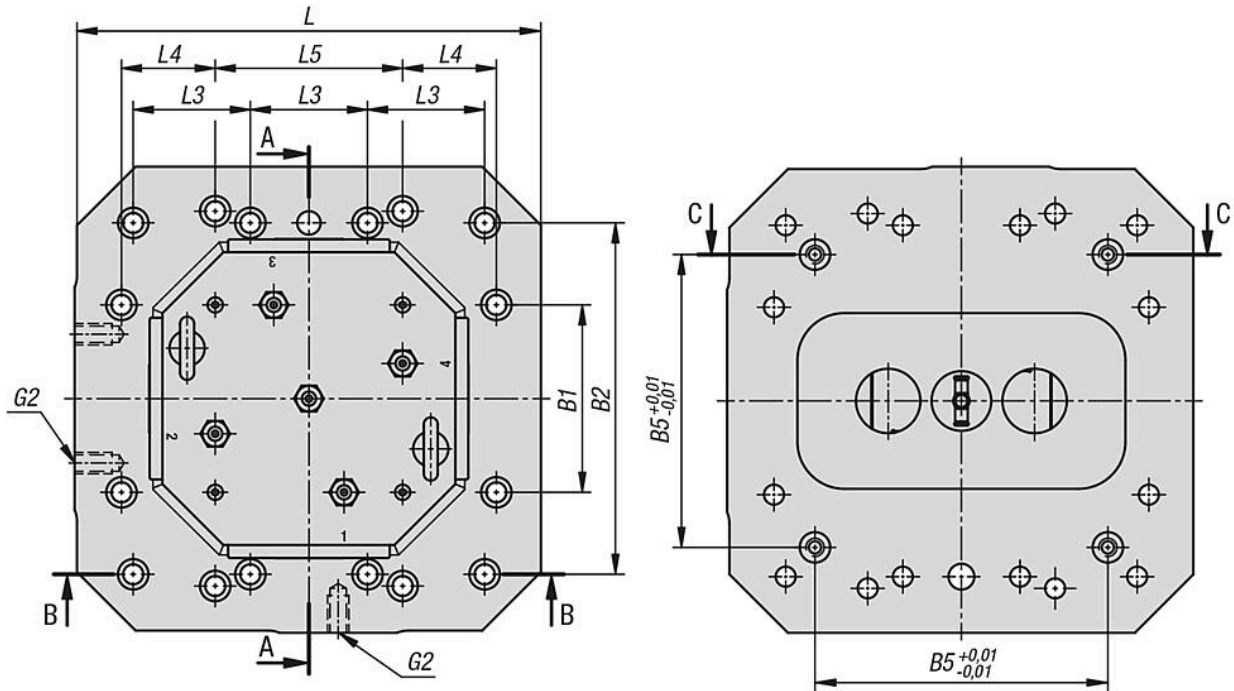

500x500

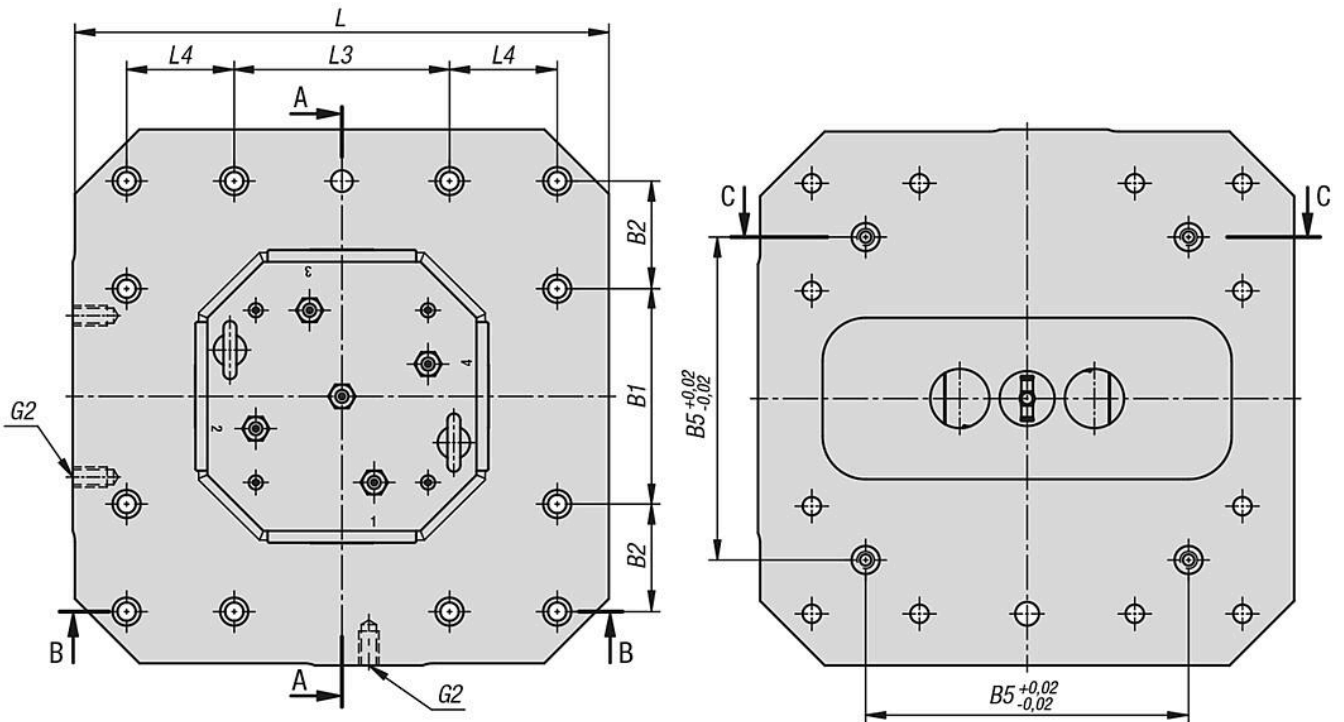

Overview of items

Workholding towers, grey cast iron, 4-sided with UNILOCK zero-point clamping system

Order No.	Version 1	Version 2	L	H	B	B1	B2	B3	B4	B5	D	D1	D2	G	G1	G2
K2363.138122004070	4 sides	with zero point clamping modules	400	713	146	160	300	150	55	250	50	20	25	M12	M16	M16
K2363.138122005070	4 sides	with zero point clamping modules	500	713	146	200	100	200	75	300	50	20	25	M12	M16	M16

Workholding towers, grey cast iron, 4-sided with UNILOCK zero-point clamping system

Overview of items

Order No.	Version 1	H1	H2	H3	H4	H5	H6	L1	L2	L3	L4	L5	L6	Retraction force with turbo kN
K2363.138122004070	4 sides	748,5	190	200	40	5,5	18	272	250	100	80	160	25	24
K2363.138122005070	4 sides	748,5	190	200	40	5,5	18	272	250	200	100	-	25	24

Order No.	Item	Version 1	Version 2	Form definition
K2363.138122004070	Clamping tower	4 sides	with zero point clamping modules	-
K2363.138122005070	Clamping tower	4 sides	with zero point clamping modules	-