

Catch plates for latches with draw bail

Item description/product images



Description

Material:

Steel or stainless steel 1.4301.

Version:

Electro zinc-plated, thick-film passivated and sealed with Top Coat.
Stainless steel bright.

Accessory:

Latch K2358.

Drawings

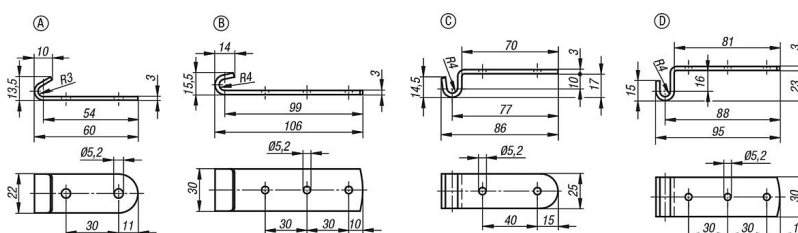

Overview of items

Catch plate

Order No.	Main material	Form
K2358.91520601	steel	A
K2358.91520602	stainless steel	A
K2358.92521061	steel	B
K2358.92521062	stainless steel	B
K2358.93520861	steel	C
K2358.93520862	stainless steel	C
K2358.94520951	steel	D
K2358.94520952	stainless steel	D