

Angle sets type B

Item description/product images



Description

Material:

Angle die-cast aluminium.
Screws and slot nuts steel.

Version:

Angle alu-tone.
Screws and slot nuts electro zinc-plated.

Note:

Suitable for reinforcing profile constructions and for frictional connection of profiles with each other without machining. Can also be used as fastening element (e.g. bracket) for components.

The angles have centring lugs for accurate and twist-proof mounting. The centring lugs can be removed if necessary by breaking them off e.g. for mounting plates. The open side can be closed off with the end cap K2187.

Accessory:

End caps K2187.

Drawings

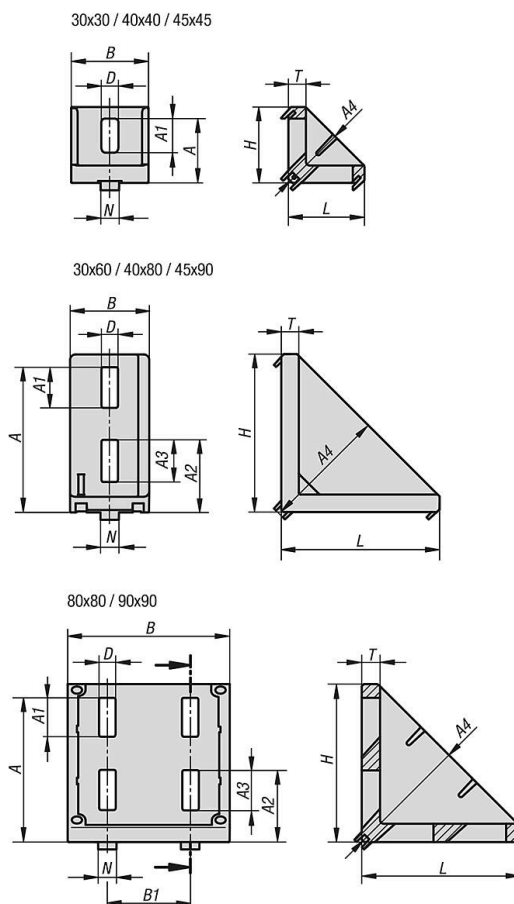

Overview of items

Angle sets type B

Overview of items

Angle sets, type B

Order No.	Type	Slot width	Version	A	A1	A2	A3	A4	B	B1	D	H	L	N	T
K2186.0830302	B	8	30x30	21,7	9,5	-	-	22,5	28	-	6,4	27,2	27,2	8	6
K2186.0830602	B	8	30x60	51	11	23	11	43	28	-	6,4	57	57	8	6
K2186.1040402	B	10	40x40	29,5	20,5	-	-	29,5	38	-	9	36	36	10	5,5
K2186.1045452	B	10	45x45	35	18,5	-	-	35,3	42	-	9,3	41,3	41,3	10	9,5
K2186.1040802	B	10	40x80	68	20	35	23	59	38	-	9	76	76	10	8,5
K2186.1045902	B	10	45x90	79	22	39,5	23	67	43	-	9	86	86	10	9,5
K2186.1080802	B	10	80x80	68,5	20	35	20	58,5	74	40	9	76	76	10	8
K2186.1090902	B	10	90x90	78,5	21	39	22	67	88	45	9	86	86	10	10