

Sealing washers DIN 7603 copper or aluminium

Item description/product images

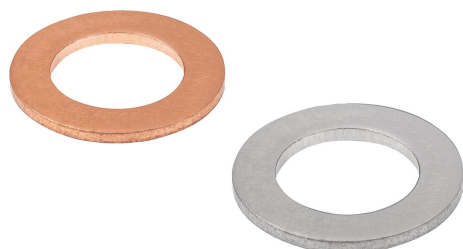

Description

Material:
Copper or aluminium.

Version:
Bright.

Note:
DIN 7603 sealing washers Form A. Used to seal static fastenings. They prevent liquids or gases from escaping and simultaneously protect the system against the ingress of dust, dirt and liquids.

Due to their corrosion resistance, copper and aluminium sealing washers can be used anywhere, with the exception of some strong acids. Thanks to their soft structure, they mould themselves into any unevenness in the parts being screwed together, thus ensuring a tight seal.

The sealing washers are used with e.g. DIN 908 screw plugs and hollow screws.

Temperature range:
Copper max. 300 °C.
Aluminium max. 200 °C.

Drawings

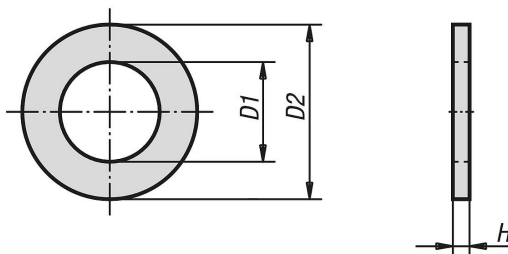

Overview of items

Sealing washers DIN 7603, copper or aluminium

Order No.	Form	Main material	D1	D2	H	Nominal size	Suitable for thread inch	Suitable for thread mm
K2078.110400080	A	copper	4,2	7,9	1	4x8	-	-
K2078.110500075	A	copper	5,2	7,4	1	5x7,5	-	-
K2078.110650095	A	copper	6,7	9,4	1	6,5x9,5	-	-
K2078.110800115	A	copper	8,2	11,4	1	8x11,5	-	M8x1
K2078.111000135	A	copper	10,2	13,4	1	10x13,5	G1/8	M10x1
K2078.111200155	A	copper	12,2	15,4	1,5	12x15,5	-	M12x1,5
K2078.111200160	A	copper	12,2	15,9	1,5	12x16	-	M12x1,5
K2078.111400180	A	copper	14,2	17,9	1,5	14x18	G1/4	M14x1,5
K2078.111400200	A	copper	14,2	19,9	1,5	14x20	G1/4	M14x1,5
K2078.111600200	A	copper	16,2	19,9	1,5	16x20	-	M16x1,5
K2078.111700210	A	copper	17,2	20,9	1,5	17x21	G3/8	-
K2078.111800220	A	copper	18,2	21,9	1,5	18x22	-	M18x1,5
K2078.112000240	A	copper	20,2	23,9	1,5	20x24	-	M20x1,5
K2078.112100260	A	copper	21,2	25,9	1,5	21x26	G1/2	-

Sealing washers DIN 7603 copper or aluminium

Overview of items

Order No.	Form	Main material	D1	D2	H	Nominal size	Suitable for thread inch	Suitable for thread mm
K2078.112200270	A	copper	22,2	26,9	1,5	22x27	-	M22x1,5
K2078.112400290	A	copper	24,3	28,9	2	24x29	-	M24x1,5
K2078.112600310	A	copper	26,3	30,9	2	26x31	-	M26x1,5
K2078.112700320	A	copper	27,3	31,9	2	27x32	G3/4	M27x2
K2078.113000360	A	copper	30,3	35,9	2	30x36	G7/8	M30x1,5
K2078.113300390	A	copper	33,3	38,9	2	33x39	G1	M33x2
K2078.113600420	A	copper	36,3	41,9	2	36x42	-	M36x1,5
K2078.113800440	A	copper	38,3	43,9	2	38x44	G1 1/8	M38x1,5
K2078.114200490	A	copper	42,3	48,9	2	42x49	G1 1/4	M42x1,5
K2078.114500520	A	copper	45,3	51,9	2	45x52	-	M45x1,5
K2078.114800550	A	copper	48,3	54,9	2	48x55	G1 1/2	M48x1,5
K2078.115000570	A	copper	50,2	56,9	2	50x57	-	-
K2078.115200600	A	copper	52,5	59,8	2,5	52x60	-	M52x1,5
K2078.115600640	A	copper	56,5	63,8	2,5	56x64	-	M56x2
K2078.116000680	A	copper	60,5	67,8	2,5	60x68	G2	M60x2
K2078.210400080	A	aluminium	4,2	7,9	1	4x8	-	-
K2078.210500075	A	aluminium	5,2	7,4	1	5x7,5	-	-
K2078.210650095	A	aluminium	6,7	9,4	1	6,5x9,5	-	-
K2078.210800115	A	aluminium	8,2	11,4	1	8x11,5	-	M8x1
K2078.211000135	A	aluminium	10,2	13,4	1	10x13,5	G1/8	M10x1
K2078.211200155	A	aluminium	12,2	15,4	1,5	12x15,5	-	M12x1,5
K2078.211200160	A	aluminium	12,2	15,9	1,5	12x16	-	M12x1,5
K2078.211400180	A	aluminium	14,2	17,9	1,5	14x18	G1/4	M14x1,5
K2078.211400200	A	aluminium	14,2	19,9	1,5	14x20	G1/4	M14x1,5
K2078.211600200	A	aluminium	16,2	19,9	1,5	16x20	-	M16x1,5
K2078.211700210	A	aluminium	17,2	20,9	1,5	17x21	G3/8	-
K2078.211800220	A	aluminium	18,2	21,9	1,5	18x22	-	M18x1,5
K2078.212000240	A	aluminium	20,2	23,9	1,5	20x24	-	M20x1,5
K2078.212100260	A	aluminium	21,2	25,9	1,5	21x26	G1/2	-
K2078.212200270	A	aluminium	22,2	26,9	1,5	22x27	-	M22x1,5
K2078.212400290	A	aluminium	24,3	28,9	2	24x29	-	M24x1,5
K2078.212600310	A	aluminium	26,3	30,9	2	26x31	-	M26x1,5
K2078.212700320	A	aluminium	27,3	31,9	2	27x32	G3/4	M27x2
K2078.213000360	A	aluminium	30,3	35,9	2	30x36	G7/8	M30x1,5
K2078.213300390	A	aluminium	33,3	38,9	2	33x39	G1	M33x2
K2078.214200490	A	aluminium	42,3	48,9	2	42x49	G1 1/4	M42x1,5
K2078.214500520	A	aluminium	45,3	51,9	2	45x52	-	M45x1,5
K2078.214800550	A	aluminium	48,3	54,9	2	48x55	G1 1/2	M48x1,5