

UNILOCK dovetail clamping bolts system size 80 mm

Item description/product images



Description

Material:

Steel.

Version:

Hardened and black oxidised.

Contact faces ground.

Note:

The UNILOCK dovetail clamping bolt is suitable for clamping and positioning workpieces and fixtures.

Clamping bolts are screwed onto the exchange element and adapted to the various basic modules.

No threads are needed to fasten the clamping bolt, as this is done by the dovetail in a clamping edge on the workpiece.

Retaining forces of up to 15,000 N can be achieved.

The following tightening torques must be observed when mounting the clamping bolt:

- Mounting in steel: 55 Nm.
- Mounting in aluminium: 17 Nm.

The turbo function of the clamping modules must not be utilised when the UNILOCK dovetail clamping bolts are used.

The alignment of the slider faces must be observed when screwing in the dovetail clamping bolts several times (accurately centred interface). By the dovetail clamping bolt Form B, the bayonet must be aligned 90° to the slide face.

Assembly:

See mounting contour.

Advantages:

- No fastening thread required in the workpiece.
- Dovetail results in low installation depths.

Supplied with:

1x UNILOCK dovetail clamping bolt with fastening screw.

Drawing reference:

- 1) Screw in once, lost interface
- 2) Screw-in several times, accurately centred interface

- a) Test shaft. Testing with balls
- b) Balls
- d) For slider face

UNILOCK dovetail clamping bolts system size 80 mm

Drawings

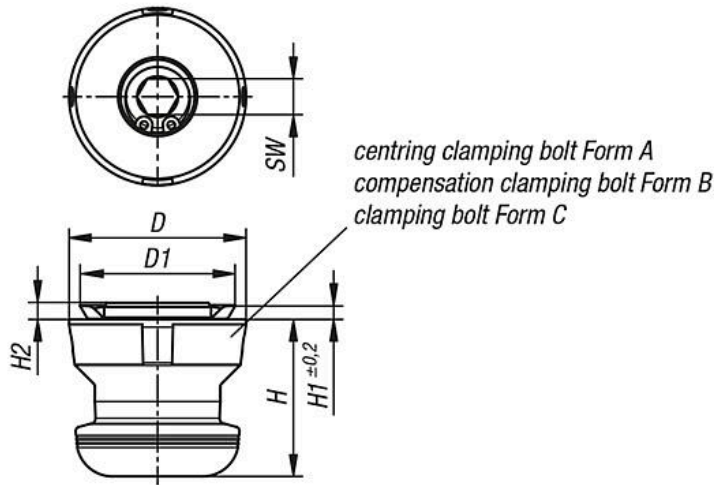

- centring clamping bolt = Form A fixes in x and y axis (reference point)
- compensation clamping bolt = Form B fixes the free axis (bayonet pin)
- clamping bolt = Form C clamping bolt with undersize (no centring function, clamping only)

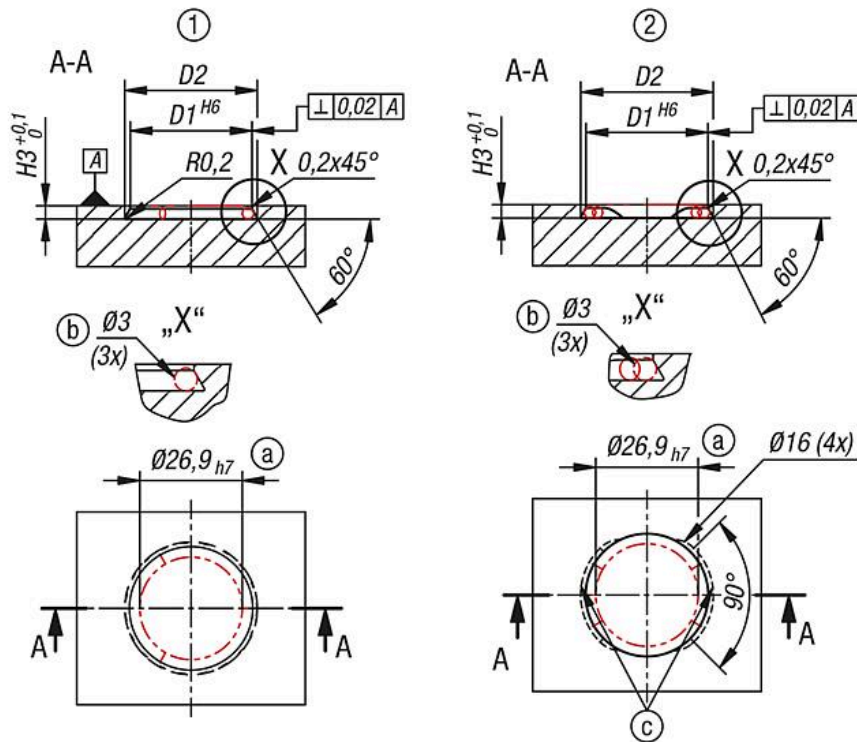
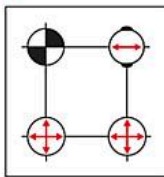

Overview of items

UNILOCK dovetail clamping bolts, system size 80 mm

UNILOCK dovetail clamping bolts system size 80 mm**Overview of items**

Order No.	Form	D	D1	D2	H	H1	H2	H3	SW
K1975.140320308	A	39,5	32	35,1	35	3,2	3,3	3,5	8
K1975.240320308	B	39,5	32	35,1	35	3,2	3,3	3,5	8
K1975.340320308	C	39,5	32	35,1	35	3,2	3,3	3,5	8