

Attachment jaws machinable for fixed jaws DS and ES

Item description/product images

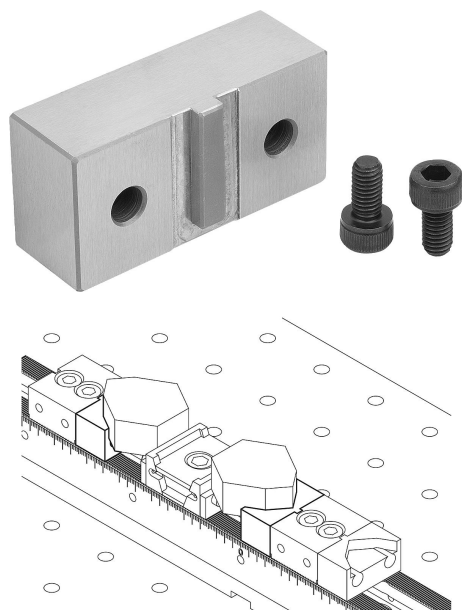

Description

Material:
Tool steel.

Version:
tempered (HRC32).

Note:
Attachment jaws are used to incorporate customer-specific workpiece contours.

Application:
The attachment jaws are screwed onto the ES and DS fixed stops.

Advantages:
Machined attachment jaws can be re-used for later series productions.

Drawings

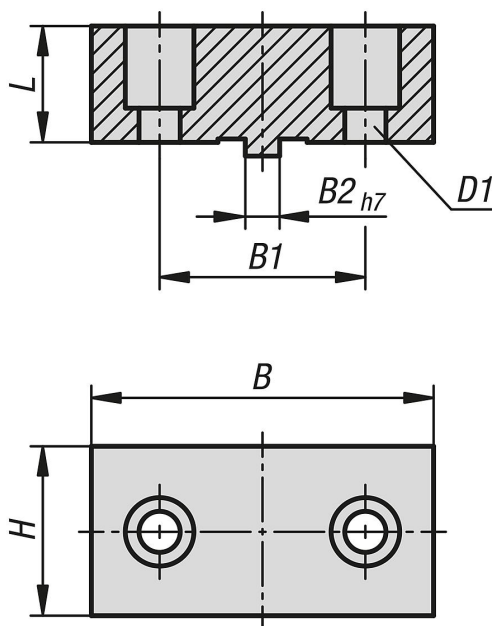

Overview of items

Attachment jaws machinable for fixed jaws DS and ES

| Order No. | suitable for system width | L | B | H | B1 | B2 | D1 for screw to DIN 912 |
|-------------|---------------------------|----|-----|----|----|----|-------------------------|
| K1753.05017 | 50 | 17 | 50 | 25 | 30 | 5 | M5 |
| K1753.05027 | 50 | 27 | 80 | 25 | 30 | 5 | M5 |
| K1753.07219 | 72 | 19 | 72 | 40 | 44 | 8 | M6 |
| K1753.07230 | 72 | 30 | 115 | 40 | 44 | 8 | M6 |
| K1753.10025 | 100 | 25 | 100 | 43 | 64 | 10 | M8 |

Attachment jaws machinable for fixed jaws DS and ES**Overview of items**

| Order No. | suitable for system width | L | B | H | B1 | B2 | D1 for screw to DIN 912 |
|--------------------|------------------------------|----|-----|----|----|----|-------------------------------|
| K1753.10035 | 100 | 35 | 150 | 43 | 64 | 10 | M8 |