

## Stainless steel cap nuts with collar

and seal and shim washer for Hygienic USIT® set

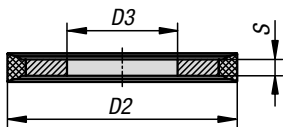
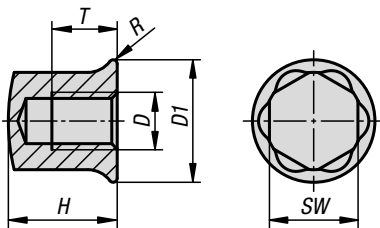
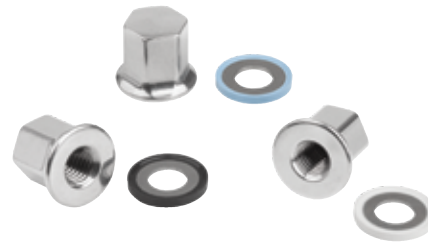

**Set: cap nut with collar K1493 + Hygienic USIT® seal and shim washer K1491.**

**Only the combination of a cap nut with collar and the Hygienic USIT® seal and shim washer assures a cavity-free seal.**

**The cap nut with collar for Hygienic USIT® seal and shim washers is ideal for fastening in sterile areas and also conform to EHEDG regulations, which is confirmed with the relevant certificate.**

**Material:**

Cap nut: stainless steel 1.4404.

Washer: stainless steel 1.4404.

Seal ring:

70 EPDM 291 (black).

70 EPDM 253815 (white).

75 Fluoroprene® XP 45 (blue).

**Version:**

Cap nut: polished.

**Sample order:**

K1594.041

**Note:**

The EHEDG certificate is only valid when a combination of cap nut with collar K1493 and specially matched Hygienic USIT® seal and shim washer K1491 is used.

**Attention:**

The function of the Hygienic USIT® screw connection system has been tested in combination with stainless steel materials and standard cleaning materials. The user must check that it is suitable for the application in question.

**Accessories:**

Hexagon head screw with collar K1492.

Sockets with plastic inserts K1361.

Ring/open-end spanner with protective caps K1362.

### KIPP Stainless steel cap nuts with collar and seal and shim washer for Hygienic USIT® set

Order No. 70 EPDM 291 black	Order No. 70 EPDM 253815 white	Order No. fluoroprene XP 41 blue	D	D1	D2	D3	H	R	S	SW	T	Approval / Certification
K1594.041	K1594.042	K1594.044	M4	10,8	9,7	4,1	9	0,45	1	7	4,8	EHEDG
K1594.051	K1594.052	K1594.054	M5	11,8	10,7	5,1	11	0,5	1	8	6	EHEDG
K1594.061	K1594.062	K1594.064	M6	14	13,1	6,1	13	0,55	1	10	7,2	EHEDG
K1594.081	K1594.082	K1594.084	M8	18	16,9	8,1	16	0,6	1	13	9,6	EHEDG
K1594.101	K1594.102	K1594.104	M10	22	21,2	10,1	20	0,75	1,5	16	12	EHEDG
K1594.121	K1594.122	K1594.124	M12	26,6	25,5	12,1	23	0,9	1,5	18	14,4	EHEDG
K1594.161	K1594.162	K1594.164	M16	35	33,9	16,1	30	1,2	1,5	24	19,2	EHEDG