

Quarter-turn latches, stainless steel

rotary knob plastic or stainless steel



Quarter-turn latches are used for replacing and locking fixtures or hatches quickly and easily. Toolless clamping shortens setup times.

Material:

Housing stainless steel.
Rotary knob thermoplastic PA (polyamide) or stainless steel.

Version:

Housing bright.
Rotary knob PA fibreglass reinforced, black.
Knob stainless steel, bright.

Sample order:

K1561.14

Note:

Stainless steel fastening screws M2 or M3 are included.

Form A mounting option for plate thickness 6 mm.
Form B mounting option for plate thickness > 6 to 14 mm.

Method of operation:

Check that the rotary knob is in the „OFF“ position. Set the lift and turn latch over the clamping pin and turn the rotary knob to the „ON“ position. When fully clamped, a click sound is heard.

Accessories:

Clamping pins K1564.

Drawing reference:

1) plate

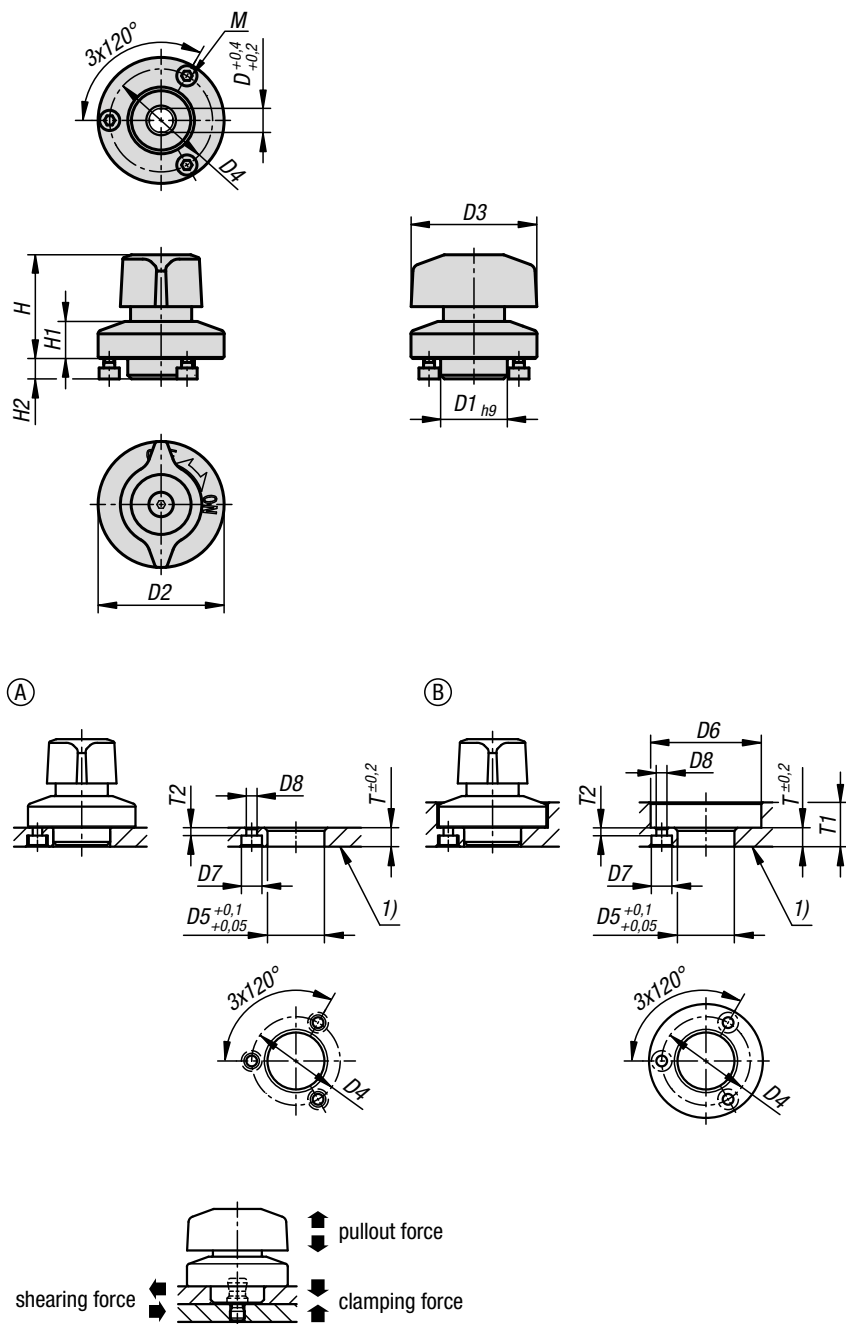

KIPP Quarter-turn latches, stainless steel, rotary knob plastic or stainless steel

Order No. polyamide	Order No. stainless steel	D	D1	D2	D3	D4	H	H1	H2	M	D5	D6	D7	D8	T	T1	T2
K1561.14	K1561.114	6	14	25	25	21	23	6,5	5,5	M2x3	14	26	4,4	2,4	6	6-10	2,5
K1561.18	K1561.118	8	18	34	34	28	28	10	5,5	M3x4	18	35	6,5	3,4	6	6-14	2,5

KIPP Lift and turn latches, technical information

Order No. polyamide	Order No. stainless steel	D	Clamping force N	Shearing force kN	Pullout force kN	Temperature resistance
K1561.14	K1561.114	6	7	1,1	0,25	≤130 °C / ≤200 °C
K1561.18	K1561.118	8	9	1,8	0,4	≤130 °C / ≤200 °C