

Hinges, stainless steel

with preset friction

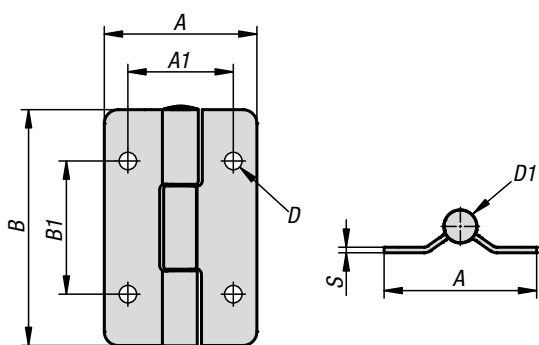

Material:
Stainless steel 1.4310.

Version:
Bright.

Sample order:
K1518.55853

Note:
Due to the constant and stable torque, the hinges permit door positioning in any angular orientation without the need for additional aids. Opening angle 270°.

Accessories:
Hinges, stainless steel K1517



KIPP Hinges, stainless steel with preset friction

Order No.	A	A1	B	B1	D	D1	S	Max. torque Nm
K1518.55853	55	38	85	48	6,3	12	2	3
K1518.55855	55	38	85	48	6,3	16	2	5