

Hinges, stainless steel

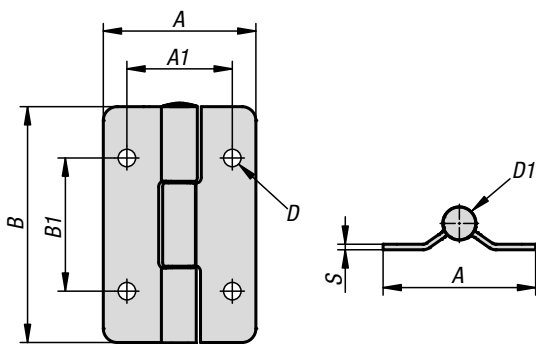

Material:
Stainless steel 1.4310.

Version:
Bright.

Sample order:
K1517.558512

Note:
Opening angle is max. 270°.

Accessories:
Hinges, stainless steel with preset friction K1518

KIPP Hinges, stainless steel

| Order No. | A | A1 | B | B1 | D | D1 | S |
|--------------|----|----|----|----|-----|----|---|
| K1517.558512 | 55 | 38 | 85 | 48 | 6,3 | 12 | 2 |
| K1517.558516 | 55 | 38 | 85 | 48 | 6,3 | 16 | 2 |