

Clamping spindles

with vulcanized neoprene thrust pad

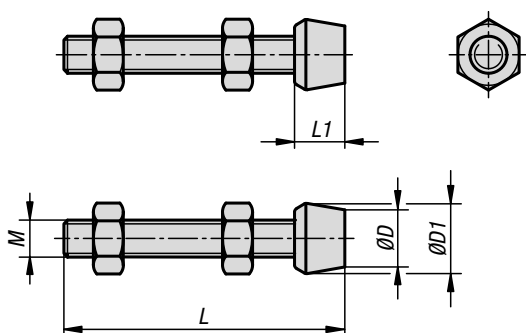

Material:

Threaded spindle and nuts in steel or stainless steel.
Thrust pad neoprene.

Version:

Threaded spindle and nuts electro zinc-plated or bright.

Sample order:

K1443.050372

KIPP Clamping spindles with vulcanised neoprene thrust pad

| Order No. | Main material | D | D1 | M | L | L1 |
|---------------|-----------------|----|----|-----|-----|-----|
| K1443.040421 | steel | 8 | 12 | M4 | 42 | 10 |
| K1443.050372 | steel | 10 | 10 | M5 | 37 | 5,7 |
| K1443.060441 | steel | 10 | 16 | M6 | 44 | 14 |
| K1443.080631 | steel | 13 | 19 | M8 | 63 | 19 |
| K1443.100851 | steel | 15 | 24 | M10 | 85 | 26 |
| K1443.121001 | steel | 25 | 31 | M12 | 100 | 26 |
| K1443.1040251 | stainless steel | 8 | 12 | M4 | 25 | 10 |
| K1443.1050421 | stainless steel | 11 | 13 | M5 | 42 | 10 |
| K1443.1060501 | stainless steel | 10 | 16 | M6 | 50 | 14 |
| K1443.1080641 | stainless steel | 13 | 19 | M8 | 64 | 19 |
| K1443.1100851 | stainless steel | 24 | 30 | M10 | 85 | 26 |