

Ball head screw

in Hygienic DESIGN

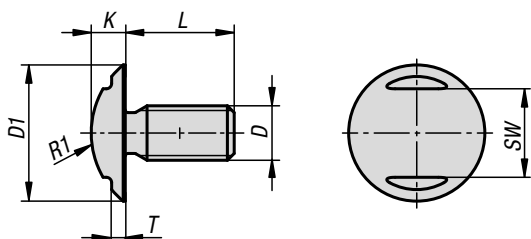

Material:

Stainless steel 1.4404.

Version:

Polished.

Sample order:

K1329.06X20 (include length L)

Note:

Ideal elements for fastening cladding panels, Plexiglas covers etc. The oversized flange and the thread undercut ensure a stress-free, uniform force distribution on the respective surfaces. Projecting edges are kept to a minimum by the head height being kept as low as possible. An open-end spanner is used to screw the fastener in.

The surface of the ball head screw is polished and, with regard to design optimised for the use in hygienic environments. The surface is polished to a surface finish of less than Ra 0.8 µm. Dirt and residue from products or cleaners seldom adheres and easy cleaning is ensured.

Accessories:

For damage-free tightening and loosening of the screw we recommend the open-end spanners together with the protective caps (K1362).

KIPP Ball head screw in Hygienic DESIGN

Order No.	D	D1	K	T	SW	R1	L
K1329.03X	M3	8	2	0,6	5	5,2	4/5/6/8/10/12/16/20/25/30
K1329.04X	M4	11	3	1	6	6,7	5/6/8/10/12/16/20/25/30
K1329.05X	M5	14	4	1	8	8,6	6/8/10/12/16/20/25/30
K1329.06X	M6	17	5	1,5	10	10	8/10/12/16/20/25/30
K1329.08X	M8	20	5	1,5	13	13	10/12/16/20/25/30/35/40
K1329.10X	M10	22	6	1,5	15	13,5	12/16/20/25/30/35/37/40
K1329.12X	M12	27	7,5	1,5	19	16,3	16/20/25/30/35/40/50
K1329.16X	M16	36	9	1,5	24	23	20/25/30/35/40/50