

Indexing plungers

with locked mark



Material:

Indexing pin steel.
Threaded sleeve.
Mushroom grip, dark grey thermoplastic.
Lock mark aluminium.

Version:

Indexing pin steel, hardened, ground and black oxidised.
Threaded sleeve black oxidised.
Lock mark red anodised.

Sample order:

K1149.71105

Note:

Indexing plungers are used to prevent any change in locking position due to lateral forces. A new locking position can only be set after the plunger has been manually disengaged.

When the lock mark is visible the plunger is either completely disengaged or only partly in the index position.

On request:

Special versions.

Accessories:

Spacer rings K0665

Drawing reference:

Form A: non-lockout type, without locknut

Form B: non-lockout type, with locknut

1) marking ring

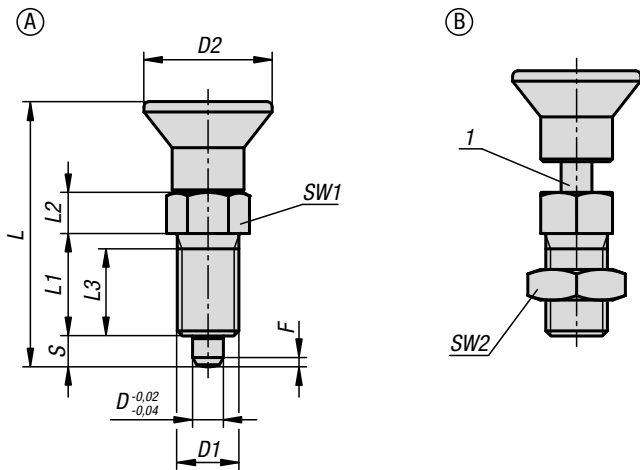
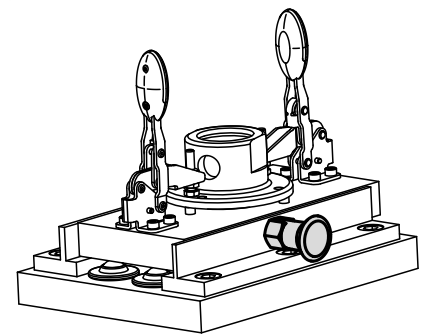

KIPP Indexing plungers with locked mark

Order No. Form A	Order No. Form B	D	D1	D2	L	L1	L2	L3	Travel S	SW1	SW2	Fx30°	Spring force initial pressure F1 approx. N	Spring force final pressure F2 approx. N
K1149.71105	K1149.72105	5	M10x1	21	43,5	17	7	15	5	13	-/17	1,3	5	12
K1149.71206	K1149.72206	6	M12x1,5	25	51,7	20	8	17	6	14	-/19	1,8	6	14
K1149.71308	K1149.72308	8	M16x1,5	33	68	26	10	23	8	19	-/24	2,3	15	35