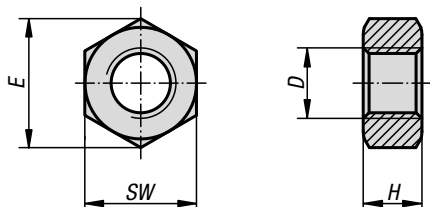

Hexagon nuts

DIN 934/DIN EN ISO 4032/DIN EN 24032

**Material:**

Steel, stainless steel A2 or stainless steel A4.

Version:

Steel grade 8, bright or electro zinc-plated.
 Steel grade 10, bright or electro zinc-plated.
 Steel grade 12, bright.
 Stainless steel A2-70, bright.
 Stainless steel A4-70, bright.

Sample order:

K1145.10

Note:

The nut grade must always be the same or higher than the bolt grade, i.e. bolts with grade 8.8 are always paired with nuts grade 8 or higher, but never less.

On request:

DIN ISO 272 spanner sizes.

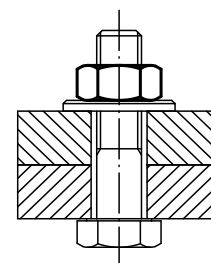

KIPP Hexagon nuts DIN 934/DIN EN ISO 4032/DIN EN 24032

| Order No. stainless steel A2 Grade 70 | Order No. stainless steel A4 Grade 70 | D | E | H | SW |
|---|---|-----|-------|-----|-----|
| K1145.103 | K1145.603 | M3 | 6,01 | 2,4 | 5,5 |
| K1145.104 | K1145.604 | M4 | 7,66 | 3,2 | 7 |
| K1145.105 | K1145.605 | M5 | 8,79 | 4 | 8 |
| K1145.106 | K1145.606 | M6 | 11,05 | 5 | 10 |
| K1145.108 | K1145.608 | M8 | 14,38 | 6,5 | 13 |
| K1145.110 | K1145.610 | M10 | 18,9 | 8 | 17 |
| K1145.112 | K1145.612 | M12 | 21,1 | 10 | 19 |
| K1145.116 | K1145.616 | M16 | 26,76 | 13 | 24 |
| K1145.120 | K1145.620 | M20 | 32,95 | 16 | 30 |
| K1145.130 | K1145.630 | M30 | 50,9 | 24 | 46 |
| K1145.136 | K1145.636 | M36 | 60,8 | 29 | 55 |
| K1145.114 | K1145.614 | M14 | 23,9 | 11 | 22 |
| K1145.122 | K1145.622 | M22 | 35 | 18 | 32 |
| K1145.124 | K1145.624 | M24 | 39,6 | 19 | 36 |
| K1145.127 | K1145.627 | M27 | 45,2 | 22 | 41 |
| K1145.133 | K1145.633 | M33 | 55,4 | 26 | 50 |

Hexagon nuts

DIN 934/DIN EN ISO 4032/DIN EN 24032



KIPP Hexagon nuts DIN 934/DIN EN ISO 4032/DIN EN 24032

| Order No. steel Grade 8 | Order No. steel Grade 10 | Order No. steel Grade 12 | Surface finish body | D | E | H | SW |
|-------------------------------|--------------------------------|--------------------------------|------------------------|-----|-------|-----|-----|
| K1145.03 | K1145.403 | - | bright (black) | M3 | 6,01 | 2,4 | 5,5 |
| K1145.04 | K1145.404 | - | bright (black) | M4 | 7,66 | 3,2 | 7 |
| K1145.05 | K1145.405 | - | bright (black) | M5 | 8,79 | 4 | 8 |
| K1145.06 | K1145.406 | K1145.506 | bright (black) | M6 | 11,05 | 5 | 10 |
| K1145.08 | K1145.408 | K1145.508 | bright (black) | M8 | 14,38 | 6,5 | 13 |
| K1145.10 | K1145.410 | K1145.510 | bright (black) | M10 | 18,9 | 8 | 17 |
| K1145.12 | K1145.412 | K1145.512 | bright (black) | M12 | 21,1 | 10 | 19 |
| K1145.14 | K1145.414 | - | bright (black) | M14 | 23,9 | 11 | 22 |
| K1145.16 | K1145.416 | K1145.516 | bright (black) | M16 | 26,76 | 13 | 24 |
| K1145.20 | K1145.420 | K1145.520 | bright (black) | M20 | 32,95 | 16 | 30 |
| K1145.22 | K1145.422 | - | bright (black) | M22 | 35 | 18 | 32 |
| K1145.24 | K1145.424 | K1145.524 | bright (black) | M24 | 39,6 | 19 | 36 |
| K1145.27 | K1145.427 | K1145.527 | bright (black) | M27 | 45,2 | 22 | 41 |
| K1145.30 | K1145.430 | K1145.530 | bright (black) | M30 | 50,9 | 24 | 46 |
| K1145.33 | K1145.433 | - | bright (black) | M33 | 55,4 | 26 | 50 |
| K1145.36 | K1145.436 | K1145.536 | bright (black) | M36 | 60,8 | 29 | 55 |
| K1145.203 | - | - | galvanised | M3 | 6,01 | 2,4 | 5,5 |
| K1145.204 | K1145.304 | - | galvanised | M4 | 7,66 | 3,2 | 7 |
| K1145.205 | K1145.305 | - | galvanised | M5 | 8,79 | 4 | 8 |
| K1145.206 | K1145.306 | - | galvanised | M6 | 11,05 | 5 | 10 |
| K1145.208 | K1145.308 | - | galvanised | M8 | 14,38 | 6,5 | 13 |
| K1145.210 | K1145.310 | - | galvanised | M10 | 18,9 | 8 | 17 |
| K1145.212 | K1145.312 | - | galvanised | M12 | 21,1 | 10 | 19 |
| K1145.214 | K1145.314 | - | galvanised | M14 | 23,9 | 11 | 22 |
| K1145.216 | K1145.316 | - | galvanised | M16 | 26,76 | 13 | 24 |
| K1145.220 | K1145.320 | - | galvanised | M20 | 32,95 | 16 | 30 |
| K1145.222 | K1145.322 | - | galvanised | M22 | 35 | 18 | 32 |
| K1145.224 | K1145.324 | - | galvanised | M24 | 39,6 | 19 | 36 |
| K1145.227 | K1145.327 | - | galvanised | M27 | 45,2 | 22 | 41 |
| K1145.230 | K1145.330 | - | galvanised | M30 | 50,9 | 24 | 46 |
| K1145.233 | K1145.333 | - | galvanised | M33 | 55,4 | 26 | 50 |
| K1145.236 | K1145.336 | - | galvanised | M36 | 60,8 | 29 | 55 |