

R-clips

similar to DIN 11024

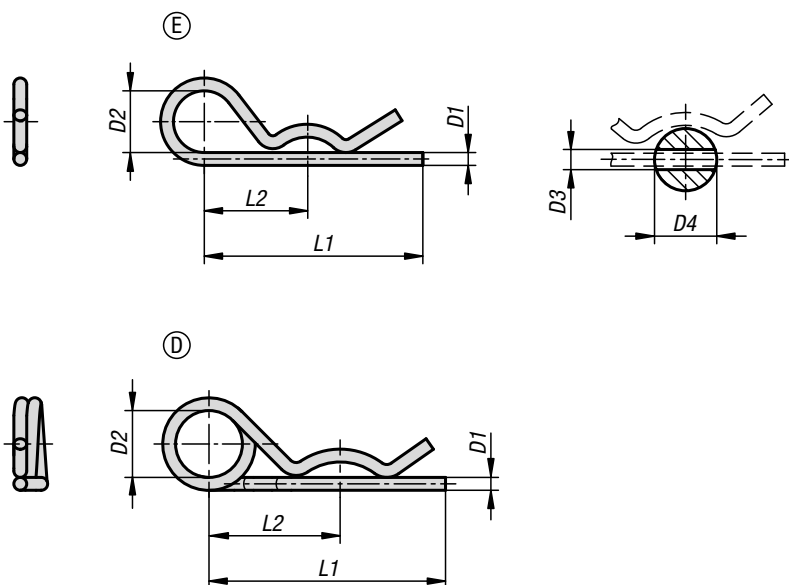

Material:
Steel or stainless steel A2.

Version:
Steel electro zinc-plated.
Stainless steel bright.

Sample order:
K1137.11200

Note:
R-clips are used for securing bolts and axles. They are easy to install and can be reused. The ends have no sharp edges.

Double coil R-clips have a flatter spring characteristics and are easier to install. The double coil allows a tether cable to be attached to prevent loss.

Drawing reference:

Form E: with single coil.
Form D: with double coil (coil direction can differ from the drawing).

KIPP R-clips similar to DIN 11024

Order No.	Form	Main material	D1	D2	D3	D4=for screw Ø	L1	L2
K1137.11200	E	steel	2	10	2,5	9-14	50	25
K1137.11300	E	steel	3	18	3,5	10-16	60	28
K1137.11400	E	steel	4	20	4,5	16-20	60	30
K1137.11500	E	steel	5	24	6	20-28	85	40
K1137.11600	E	steel	6	30	7	28-40	105	50
K1137.11700	E	steel	7	30	8	28-45	105	50
K1137.21200	E	stainless steel A2	2	10	2,5	7-8	40	25
K1137.21250	E	stainless steel A2	2,5	11	3	10-16	46	24
K1137.21300	E	stainless steel A2	3	16	3,5	16-18	60	34
K1137.21400	E	stainless steel A2	4	19	4,5	18-20	64	36
K1137.21500	E	stainless steel A2	5	26	6	20-28	82	45
K1137.21600	E	stainless steel A2	6	30	7	28-40	110	60

Order No.	Form	Main material	D1	D2	D3	D4=for screw Ø	L1	L2
K1137.12225	D	steel	2,25	20	2,5	9-11,2	42	24
K1137.12280	D	steel	2,8	20	3,2	11,2-14	48	26
K1137.12360	D	steel	3,6	20	4	14-20	64	32
K1137.12450	D	steel	4,5	25	5	20-26	80	39
K1137.12560	D	steel	5,6	25	6,3	26-34	97	45
K1137.12630	D	steel	6,3	30	7	34-45	125	56
K1137.12700	D	steel	7	30	8	45-56	150	63
K1137.22225	D	stainless steel A2	2,25	20	2,5	7-9	42	24
K1137.22280	D	stainless steel A2	2,8	20	3,2	11-14	48	26
K1137.22360	D	stainless steel A2	3,6	20	4	14-20	64	32
K1137.22450	D	stainless steel A2	4,5	25	5	20-26	80	39
K1137.22560	D	stainless steel A2	5,6	25	6,3	26-34	97	45