

Rest pads

pin form, internal thread

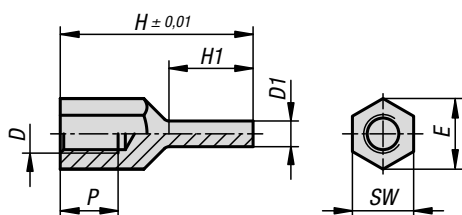

Material:

Carbon steel.

Version:

Tempered, black oxidised.

Seating face inductively hardened and ground.

Sample order:

K1105.2060420

Note:

The rest pads can be used both as a stable and precise support and as a stop.

The pin form of the rest pad also allows it to be used with components with constricted support points.

KIPP Rest pads, pin form with internal thread

Order No.	D	D1	E	H	H1	P	SW
K1105.2060420	M6	4	11	20	8,5	6	10
K1105.2060430	M6	4	11	30	13,5	9	10
K1105.2080430	M8	4	14,4	30	13	10	13
K1105.2080440	M8	4	14,4	40	18	14	13
K1105.2080630	M8	6	14,4	30	13	10	13
K1105.2080640	M8	6	14,4	40	18	14	13
K1105.2100630	M10	6	19	30	12	10	17
K1105.2100650	M10	6	19	50	25	15	17
K1105.2100830	M10	8	19	30	12	10	17
K1105.2100850	M10	8	19	50	25	15	17
K1105.2120640	M12	6	21,2	40	18	12	19
K1105.2120660	M12	6	21,2	60	28	18	19
K1105.2120840	M12	8	21,2	40	18	12	19
K1105.2120860	M12	8	21,2	60	28	18	19

Rest pads

pin form, external thread

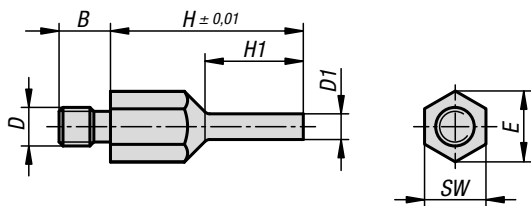

Material:

Carbon steel.

Version:

Tempered, black oxidised.

Seating face inductively hardened and ground.

Sample order:

K1105.1060420

Note:

The rest pads can be used both as a stable and precise support and as a stop.

The pin form of the rest pad also allows it to be used with components with constricted support points.

KIPP Rest pads, pin form with external thread

Order No.	B	D	D1	E	H	H1	SW
K1105.1060420	8	M6	4	11	20	10	10
K1105.1060430	8	M6	4	11	30	15	10
K1105.1080430	10	M8	4	14,4	30	15	13
K1105.1080440	10	M8	4	14,4	40	20	13
K1105.1080630	10	M8	6	14,4	30	15	13
K1105.1080640	10	M8	6	14,4	40	20	13
K1105.1100630	14	M10	6	19	30	15	17
K1105.1100650	14	M10	6	19	50	25	17
K1105.1100830	14	M10	8	19	30	15	17
K1105.1100850	14	M10	8	19	50	25	17
K1105.1120640	14	M12	6	21,2	40	20	19
K1105.1120660	14	M12	6	21,2	60	30	19
K1105.1120840	14	M12	8	21,2	40	20	19
K1105.1120860	14	M12	8	21,2	60	30	19