

## Knurled knobs

aluminium



**Material:**

Body aluminium.  
Cap thermoplastic PA6.  
Grub screw stainless steel.

**Version:**

Body black anodised.  
Cap light grey RAL 7035.  
Grub screw bright.

**Sample order:**

K1099.27085

**On request:**

Other female threads, colours and special versions.

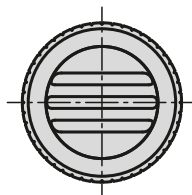
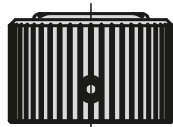
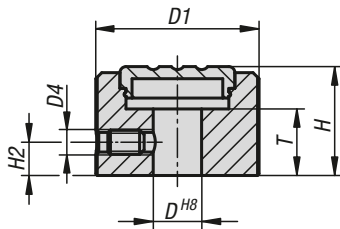

### KIPP Knurled knobs aluminium

Order No.	D	D1	D4	H	H2	T
K1099.27085	8	27	M4	18	5,5	11
K1099.27105	10	27	M4	18	5,5	11
K1099.34105	10	34	M5	21	7	14
K1099.34125	12	34	M5	21	7	14
K1099.42125	12	42	M5	24,5	8,5	15
K1099.42145	14	42	M5	24,5	8,5	15