

Indexing plungers

short version, with thread lock

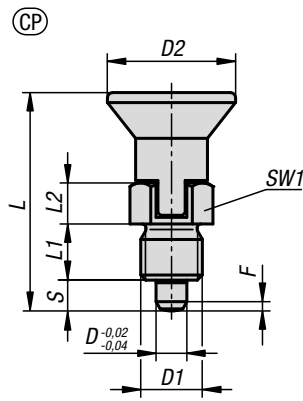
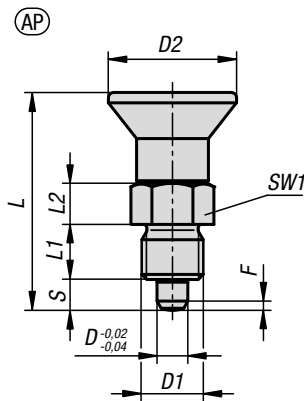

Material:

Steel version:

Indexing pin hardened:

Threaded sleeve and indexing pin steel.

Stainless steel version:

Indexing pin not hardened:

Threaded sleeve and indexing pin 1.4305.

Mushroom knob black grey thermoplastic.

Thread lock blue polyamide.

Version:

Steel version:

Indexing pin hardened, ground, black oxidised.

Stainless steel version:

Indexing pin not hardened, ground, bright.

Sample order:

K1097.95903

Note:

Indexing plungers are used to prevent any change in locking position due to lateral forces. A new locking position can only be set after the pin has been manually disengaged. Form CP is recommended for applications where the plunger remains disengaged over a long period and the pin should be prevented from springing back.

The thread lock enables the plunger to be screwed in to the exact depth required, no spacer ring is required. The thread lock is a gripping polyamide coating that is applied punctiform (spot).

On request:

Special versions.

Accessories:

Spacer rings K0665

Drawing reference:

Form AP: non-lockout type, without locknut

Form CP: lockout type, without locknut

Indexing plungers

short version, with thread lock



KIPP Indexing plungers, short version, with thread lock, steel, indexing pin hardened

Order No. Form AP	Order No. Form CP	D	D1	D2	L	L1	L2	Travel S	SW1	Fx30°	Spring force initial pressure F1 approx. N	Spring force final pressure F2 approx. N
K1097.95903	K1097.97903	3	M6x0,75	14	25,5	6	5	3,5	8	0,8	4	10
K1097.95004	K1097.97004	4	M8x1	18	29,5	6	6	4	10	1	4	12
K1097.95105	K1097.97105	5	M10x1	21	34,5	8	7	5	13	1,3	5	12
K1097.95206	K1097.97206	6	M12x1,5	25	41,7	10	8	6	14	1,8	6	14
K1097.95308	K1097.97308	8	M16x1,5	33	54	12	10	8	19	2,3	14	28
K1097.95410	K1097.97410	10	M20x1,5	33	61	15	12	10	22	2,8	15	32

KIPP Indexing plungers, short version, with thread lock, stainless steel, indexing pin not hardened

Order No. Form AP	Order No. Form CP	D	D1	D2	L	L1	L2	Travel S	SW1	Fx30°	Spring force initial pressure F1 approx. N	Spring force final pressure F2 approx. N
K1097.195903	K1097.197903	3	M6x0,75	14	25,5	6	5	3,5	8	0,8	4	10
K1097.195004	K1097.197004	4	M8x1	18	29,5	6	6	4	10	1	4	12
K1097.195105	K1097.197105	5	M10x1	21	34,5	8	7	5	13	1,3	5	12
K1097.195206	K1097.197206	6	M12x1,5	25	41,7	10	8	6	14	1,8	6	14
K1097.195308	K1097.197308	8	M16x1,5	33	54	12	10	8	19	2,3	14	28
K1097.195410	K1097.197410	10	M20x1,5	33	61	15	12	10	22	2,8	15	32