

## Locating pins

with internal thread

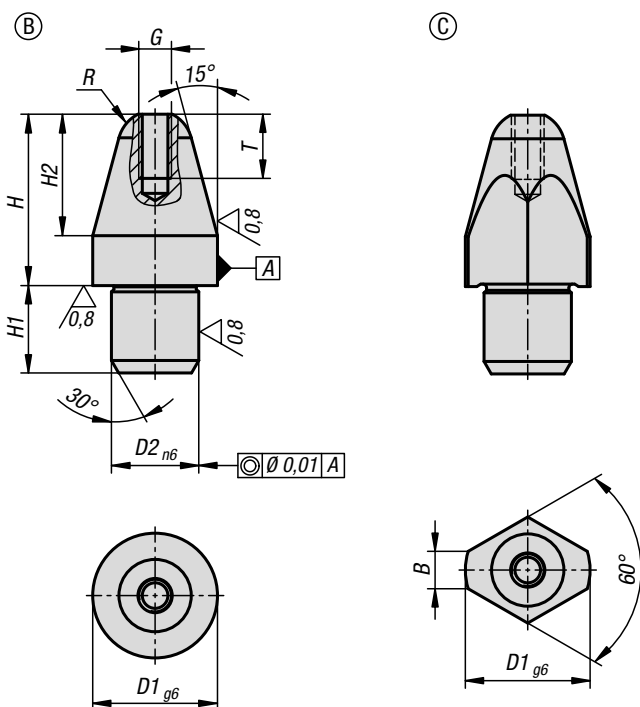

**Material:**  
Steel.

**Version:**  
Hardened and ground (HRC 60 ±2).

**Sample order:**  
K1094.208

**Note:**  
The locating pins are designed to make the joining process easier. Used in combination with hardened locating bushes K1095, they enable exact, low-wear, and fast changes of the workpiece.

Versions D1 = 5 and D1 = 6 do not have an internal thread.

**Drawing reference:**  
Form B: cylindrical pin  
Form C: rhomboid pin

### KIPP Locating pins, short

Order No. Form B	Order No. Form C	Version 1	D1	D2	G	H	H1	H2	R	B	T
K1094.205	K1094.405	short	5	3	-	8	3	5	1,50	-/-	-
K1094.206	K1094.406	short	6	4	-	10	4	6	1,80	-/-	-
K1094.208	K1094.408	short	8	6	M2,5	11,4	6	7,4	2,5	-/2,5	5
K1094.210	K1094.410	short	10	7	M2,5	13,7	7	9,7	3	-/3,0	5
K1094.212	K1094.412	short	12	8	M3	16	8	12	3,5	-/3,5	6
K1094.216	K1094.416	short	16	12	M4	20	12	15	5	-/5	8
K1094.220	K1094.420	short	20	14	M5	25,5	14	19,5	6	-/6	10

### KIPP Locating pins, long

Order No. Form B	Order No. Form C	Version 1	D1	D2	G	H	H1	H2	R	B	T
K1094.305	K1094.505	long	5	3	-	10	3	5	1,50	-/-	-
K1094.306	K1094.506	long	6	4	-	12	4	6	1,80	-/-	-
K1094.308	K1094.508	long	8	6	M2,5	17,4	6	7,4	2,5	-/2,5	5
K1094.310	K1094.510	long	10	7	M2,5	21,7	7	9,7	3	-/3,0	5
K1094.312	K1094.512	long	12	8	M3	24	8	12	3,5	-/3,5	6
K1094.316	K1094.516	long	16	12	M4	29	12	15	5	-/5	8
K1094.320	K1094.520	long	20	14	M5	35,5	14	19,5	6	-/6	10