

## Star grips



**Material:**

Fibreglass reinforced thermoplastic.  
Tapped bush brass.  
Screw steel.

**Version:**

Grip, black.  
Screw electro zinc-plated.

**Sample order:**

K1090.43006X16 (include length L)

**Drawing reference:**

Form D: tapped bush, without cap

Form K: tapped bush

Form L: external thread

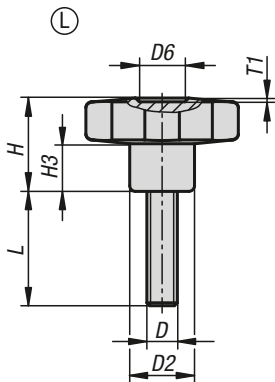
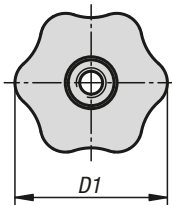
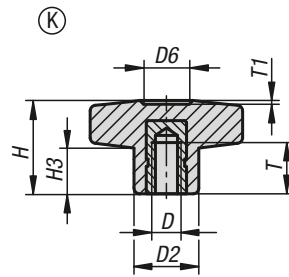
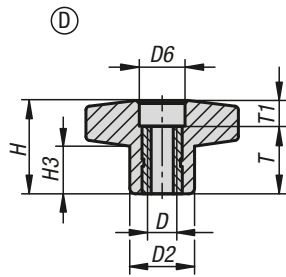



## KIPP Form D, tapped bush, without cap

Order No.	Form	D	D1	D2	D6	H	H3	T	T1
K1090.53005	D	M5	30	15	11	22	11	18	4
K1090.53006	D	M6	30	15	11	22	11	18	4
K1090.53008	D	M8	30	15	11	22	11	18	4
K1090.54006	D	M6	40	17	12,5	24,5	12,5	18	6
K1090.54008	D	M8	40	17	12,5	24,5	12,5	18	6
K1090.54010	D	M10	40	17	12,5	24,5	12,5	18	6
K1090.55008	D	M8	50	20	14	29	15,5	18	11
K1090.55010	D	M10	50	20	14	29	15,5	18	11
K1090.55012	D	M12	50	20	14	29	14	18	11
K1090.56010	D	M10	60	24	16,5	34	18	18	16
K1090.56012	D	M12	60	24	16,5	34	18	18	16

## KIPP Form K, tapped bush

Order No.	Form	D	D1	D2	D6	H	H3	T	T1
K1090.23005	K	M5	30	15	9	22	11	14	1,5
K1090.23006	K	M6	30	15	9	22	11	10	1,5
K1090.24006	K	M6	40	17	12	24,5	12	16	1
K1090.24008	K	M8	40	17	12	24,5	12	14	1
K1090.24010	K	M10	40	17	12	24,5	12	14	1
K1090.25008	K	M8	50	20	14,5	29	15,5	14	1,5
K1090.25010	K	M10	50	20	14,5	29	15,5	14	1,5
K1090.25012	K	M12	50	20	14,5	29	15,5	18	1,5
K1090.26010	K	M10	60	24	18	34	18	21	1,5
K1090.26012	K	M12	60	24	18	34	18	18	1,5

## KIPP Form L, external thread

Order No.	Form	D	D1	D2	D6	H	H3	T1	L
K1090.43006X	L	M6	30	15	9	22	11	1,5	16/20/30
K1090.43008X	L	M8	30	15	9	22	11	1,5	16/20/30/40
K1090.44006X	L	M6	40	17	12	24,5	12,5	1	16/20/30/40
K1090.44008X	L	M8	40	17	12	24,5	12,5	1	20/30/40/50
K1090.45008X	L	M8	50	20	14,5	29	15	1,5	20/30/40
K1090.45010X	L	M10	50	20	14,5	29	15	1,5	20/30/40/50
K1090.46010X	L	M10	60	24	18	34	18	1,5	20/30/40/50
K1090.46012X	L	M12	60	24	18	34	18	1,5	20/30/40/50