

Recessed handles

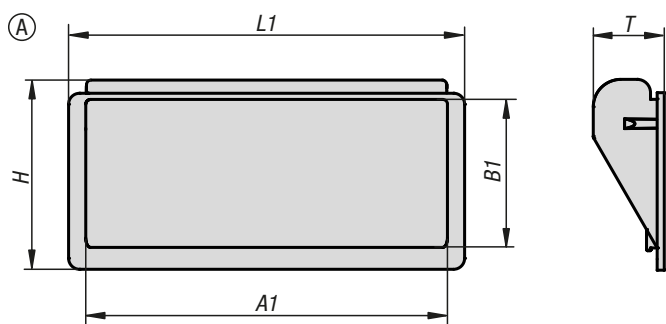

The ergonomic form of the recessed handle is ideally suited for appliances and housings. It is installed by pressing in and clipping into the mounting opening.

Material:
Thermoplastic (ABS).

Version:
black.

Sample order:
K1077.1101

Note:
This handle can be used with a wall thickness of 0.75 to 1.5 mm.
The retaining force is 750 N per pair for steel and sheet steel housings.

K1077.1101 is supplied with spring clips for mounting on the inside wall of the housing.

KIPP Recessed handles

Order No.	Version 2	A1	B1	H	L1	T	Mounting cutout	Load capacity N
K1077.0901	plug-in	79	30	40	90	16	83 x 34	375
K1077.1101	plug-in	95	33,8	56,3	110	18	103 x 49	375