

Shim plates

for sliding clamps for slotted hole

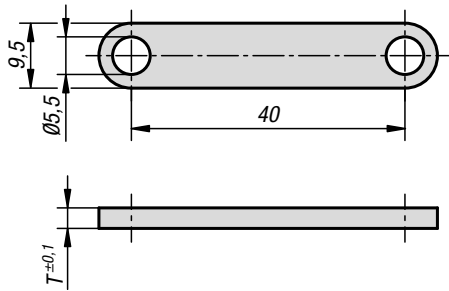

Material:
Stainless steel

Version:
Bright.

Sample order:
K1071.2

Note:
Shim plates are required for sliding clamps for slotted holes with a plate thickness more than 3 mm or 6 mm.

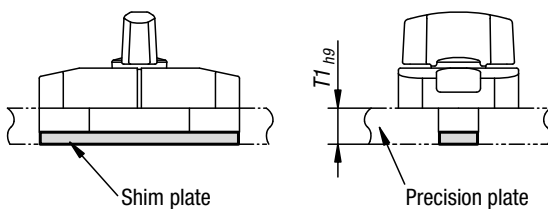

Sliding clamp for slotted holes	Suitable shim plate	Precision plate T1 (mm)
K1070.31	-	3 _{-0,25}
K1070.32	K1071.2	5 _{-0,3}
K1070.61	-	6 _{-0,3}
K1070.62	K1071.2	8 _{-0,36}
	K1071.3	9 _{-0,36}

KIPP Shim plates for sliding clamps for slotted hole

Order No.	T
K1071.2	2
K1071.3	3