

## Locking pin

for ball lock bushes



**Material:**  
Steel.

**Version:**  
Bright.

**Sample order:**  
K1067.8

**Note:**  
Repeat accuracy  $\pm 0.25$ .  
The repeat accuracy can be increased with the aid of locating pins.

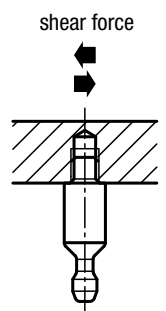
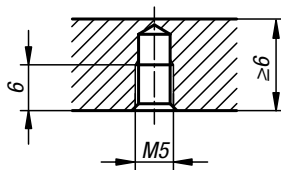
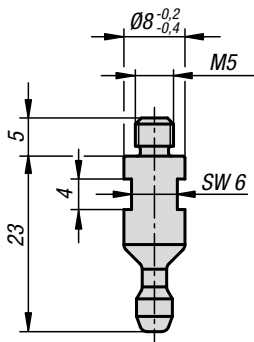

### KIPP Locking pin for ball lock bushes

Order No.	Shearing force kN	Temperature resistance
K1067.8	1,8	$\leq 180$ °C