

Drill bushes cylindrical

DIN 179

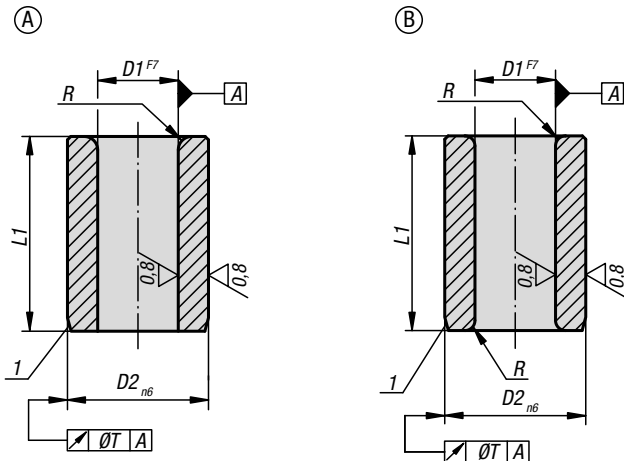

Material:

Special low carbon steel

Version:

Hardened to 740 ±80 HV 10 and ground.

Sample order:

K1021.A0120X06
(cylindrical drill bush, Form A with
D1 = 1.2 mm and L1 = 6 mm)

Note:

From diameter D1 over 15 mm size increases are
0.5 mm.

Drawing reference:

Form A: hole rounded one end
Form B: hole rounded both ends

1) Chamfer for insert

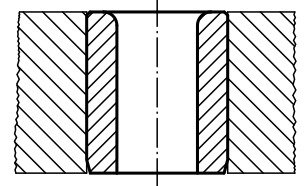

KIPP Drill bushes cylindrical DIN 179

D1	D2	L1	Product type	R	T
from 0.4 to 0.8	3	6	short	1	0,01
from 0.9 to 1.0	3	6/9	short/medium	1	0,01
from 1.1 to 1.8	4	6/9	short/medium	1	0,01
from 1.9 to 2.6	5	6/9	short/medium	1	0,01
from 2.7 to 3.3	6	12/16/8	medium/long/short	1	0,01
from 3.4 to 4.0	7	8/12/16	short/medium/long	1	0,01
from 4.1 to 5.0	8	8/12/16	short/medium/long	1	0,01
from 5.1 to 6.0	10	10/16/20	short/medium/long	1,5	0,02
from 6.1 to 8.0	12	10/16/20	short/medium/long	1,5	0,02
from 8.1 to 10.0	15	12/20/25	short/medium/long	2	0,02
from 10.1 to 12.0	18	12/20/25	short/medium/long	2	0,02
from 12.1 to 15.0	22	16/28/36	short/medium/long	2	0,02
from 15.5 to 18.0	26	16/28/36	short/medium/long	2	0,02
from 18.5 to 22.0	30	20/36/45	short/medium/long	3	0,02
from 22.5 to 26.0	35	20/36/45	short/medium/long	3	0,02
from 26.5 to 30.0	42	25/45/56	short/medium/long	3	0,02
from 30.5 to 35.0	48	25/45/56	short/medium/long	3	0,04
from 35.5 to 42.0	55	30/56/67	short/medium/long	3,5	0,04
from 42.5 to 48.0	62	30/56/67	short/medium/long	3,5	0,04