

## Crank handles aluminium

with safety grip



**Material:**  
Crank AISi9Cu3 3.2163.  
Safety cylinder grip thermoplastic PA6 and steel.

**Version:**  
Crank black powder coated.  
Thermoplastic black.  
Steel parts black oxidised.

**Sample order:**  
K0998.1110

**Note:**  
Similar to DIN 469.

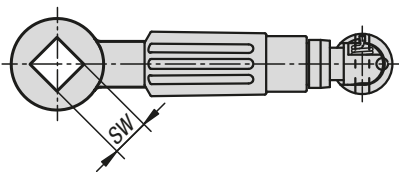
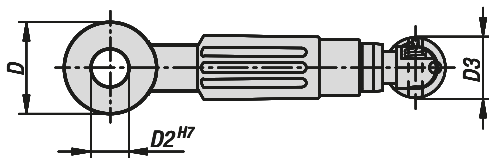
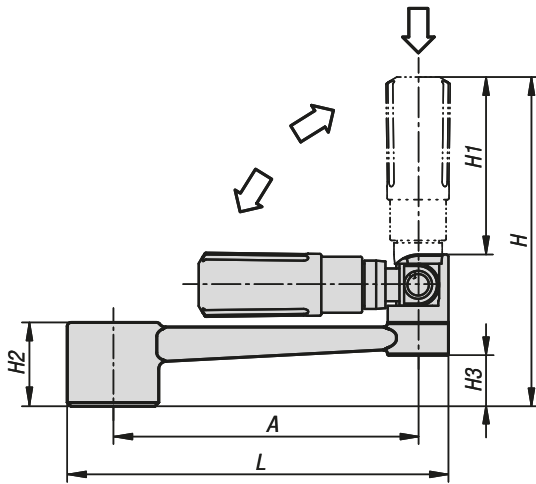

### KIPP Crank handle aluminium with safety cylinder grip

Order No.	Version 1	Version 2	A	D	D2	D3	H	H1	H2	H3	L
K0998.1110	reamed hole	without transverse hole	80	24	10	16	87,5	47,5	22	13,6	100
K0998.1212	reamed hole	without transverse hole	100	28	12	20	107	58,5	25	16	124
K0998.1314	reamed hole	without transverse hole	125	30	14	25	139	82	28	15,8	153
K0998.1417	reamed hole	without transverse hole	160	34	17	25	143	82	32	19,6	190

Order No.	Version 1	Version 2	A	D	D3	H	H1	H2	H3	L	SW
K0998.2110	square socket	without transverse hole	80	24	16	87,5	47,5	22	13,6	100	10
K0998.2212	square socket	without transverse hole	100	28	20	107	58,5	25	16	124	12
K0998.2314	square socket	without transverse hole	125	30	25	139	82	28	15,8	153	14
K0998.2417	square socket	without transverse hole	160	34	25	143	82	32	19,6	190	17