

Socket head screws

DIN EN ISO 4762 with thread lock

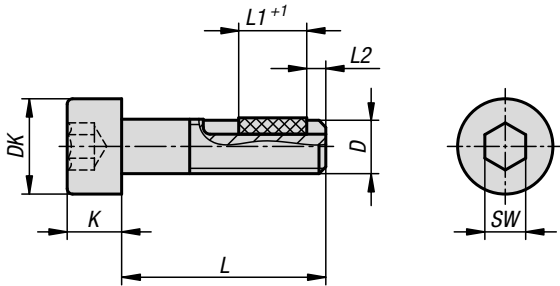

KIPPlock



Material:

Steel or stainless steel (A 2).

Thread lock nylon.

Version:

Steel grade 8.8, black.

Stainless steel A2-70, bright.

Sample order:

K0869.806X20 (include length L)

Drawing reference:

L2 = approx. 2x thread pitch



KIPP Socket head screws DIN EN ISO 4762 with thread lock

Order No. steel	Order No. stainless steel A2	D	DK	K	L	L1	SW	Tightening torque approx. Nm	Loosening torque approx. Nm
K0869.804X	K0869.904X	M4	7	4	10/12/16/20/25	5/5/6/7/7	3	0,15	0,22
K0869.805X	K0869.905X	M5	8,5	5	10/12/16/20/25/30/40	5/6/7/7/8/8/8	4	0,25	0,1
K0869.806X	K0869.906X	M6	10	6	10/12/16/20/25/30/35/40/45/50	5/6/7/7/8/8/8/8/8	5	0,45	0,25
K0869.808X	K0869.908X	M8	13	8	16/20/25/30/35/40/45	7/8/8/8/10/10/10	6	0,8	0,4
K0869.810X	K0869.910X	M10	16	10	25/30/40/50	10/10/12/12	8	1,7	0,9
K0869.812X	K0869.912X	M12	18	12	30/40/50	10/12/12	10	1,8	0,9

Socket head screws

DIN EN ISO 4762 enhanced, steel or stainless steel



Material:

Steel, stainless steel A2 or stainless steel A4.

Version:

Steel grade 8.8, bright (black) or electro zinc-plated.
 Steel grade 10.9, bright (black) or electro zinc-plated.
 Steel grade 12.9, bright (black)
 Stainless steel A2-70, bright.
 Stainless steel A4-70, bright.

Sample order:

K0869.08X40 (include length L)

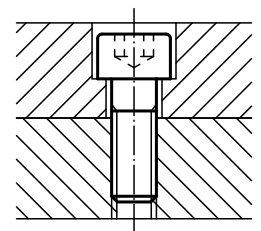
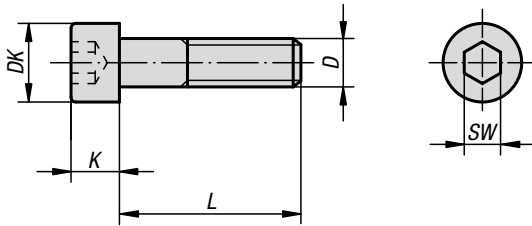

KIPP Socket head screws, DIN EN ISO 4762 enhanced, steel or stainless steel

Order No. steel bright (black)	Order No. steel galvanised	Grade	D	L	DK	K	SW
K0869.04X	K0869.404X	8.8	M4	10/12/16/18/20/25	7	4	3
K0869.05X	K0869.405X	8.8	M5	10/12/16/18/20/25/30/40	8,5	5	4
K0869.06X	K0869.406X	8.8	M6	10/12/16/18/20/25/30/35/40/45/50/55/60	10	6	5
K0869.08X	K0869.408X	8.8	M8	16/18/20/25/30/35/40/45/50/60/70/80	13	8	6
K0869.10X	K0869.410X	8.8	M10	16/18/20/25/30/35/40/45/50/60/70/80/90/100	16	10	8
K0869.12X	K0869.412X	8.8	M12	20/25/30/35/40/45/50/60/70/80/90/100/110/120	18	12	10
K0869.14X	K0869.414X	8.8	M14	50/80/120	21	14	12
K0869.16X	K0869.416X	8.8	M16	30/35/40/45/50/60/70/80/90/100/110/120	24	16	14
K0869.20X	K0869.420X	8.8	M20	40/45/50/60/70/80/90/100/110/120	30	20	17

Socket head screws

DIN EN ISO 4762 enhanced, steel or stainless steel



Order No. steel bright (black)	Order No. steel galvanised	Grade	D	L	DK	K	SW
K0869.304X	K0869.504X	10.9	M4	10/12/16/18/20/25	7	4	3
K0869.305X	K0869.505X	10.9	M5	10/12/16/18/20/25/30/40	8,5	5	4
K0869.306X	K0869.506X	10.9	M6	10/12/16/18/20/25/30/35/40/45/50/60	10	6	5
K0869.308X	K0869.508X	10.9	M8	16/18/20/25/30/35/40/45/50/60/70/80	13	8	6
K0869.310X	K0869.510X	10.9	M10	16/18/20/25/30/35/40/45/50/60/70/80/90/100	16	10	8
K0869.312X	K0869.512X	10.9	M12	20/25/30/35/40/45/50/60/70/80/90/100/110/120	18	12	10
K0869.314X	K0869.514X	10.9	M14	50/80/120	21	14	12
K0869.316X	K0869.516X	10.9	M16	30/35/40/45/50/60/70/80/90/100/110/120	24	16	14
K0869.320X	K0869.520X	10.9	M20	40/45/50/60/70/80/90/100/110/120	30	20	17

Order No. steel bright (black)	Grade	D	DK	K	L	SW
K0869.206X	12.9	M6	10	6	18/20/25/30/35/40/45/50/55/60/65/70/80/90/100	5
K0869.208X	12.9	M8	13	8	20/25/30/35/40/45/50/55/60/65/70/80/90/100/120	6
K0869.210X	12.9	M10	16	10	30/35/40/45/50/55/60/65/70/75/80/90/100/110/120/130/140	8
K0869.212X	12.9	M12	18	12	30/35/40/45/50/55/60/65/70/75/80/90/100/110/120/130/140	10
K0869.216X	12.9	M16	24	16	35/40/45/50/55/60/65/70/75/80/90/100/110/120/130/140/150/160/170/180/200	14
K0869.218X	12.9	M18	27	18	35/40/45/50/55/60/65/70/75/80/90/100/110/120/130/140/150/160/170/180/200	14
K0869.220X	12.9	M20	30	20	40/45/50/55/60/65/70/75/80/90/100/110/120/130/140/150/160/170/180/200	17

Order No. stainless steel A2	Order No. stainless steel A4	D	L	DK	K	SW
K0869.104X	K0869.604X	M4	10/12/16/18/20/25	7	4	3
K0869.105X	K0869.605X	M5	10/12/16/18/20/25/30/40	8,5	5	4
K0869.106X	K0869.606X	M6	10/12/16/18/20/25/30/35/40/45/50/55/60	10	6	5
K0869.108X	K0869.608X	M8	16/18/20/25/30/35/40/45/50/60/70/80	13	8	6
K0869.110X	K0869.610X	M10	16/18/20/25/30/35/40/45/50/60/70/80/90/100	16	10	8
K0869.112X	K0869.612X	M12	20/25/30/35/40/45/50/60/70/80/90/100/110/120	18	12	10
K0869.114X	K0869.614X	M14	50/80/120	21	14	12
K0869.116X	K0869.616X	M16	30/35/40/45/50/60/70/80/90/100/110/120	24	16	14
K0869.120X	K0869.620X	M20	40/45/50/60/70/80/90/100/110/120	30	20	17