

Grub screw with hexagon socket and pointed end

DIN EN ISO 4027

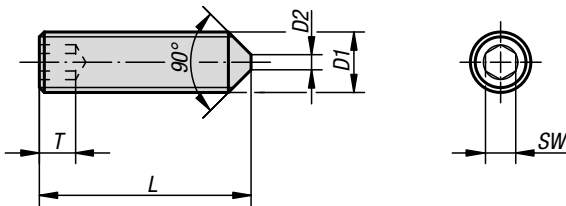

Material:

Steel or stainless steel A2.

Version:

Steel class 45 H, black.

Stainless steel A2-70, bright.

Sample order:

K0797.110X12 (include length L)

Note:

By M4x5, M5x5, M5x6, M6x6, M8x8, M10x10 the point angle is 120°.

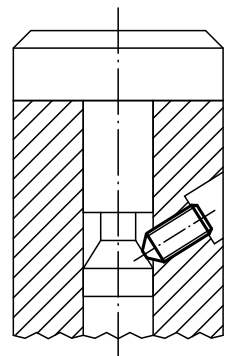

KIPP Grub screw with hexagon socket and pointed end, DIN EN ISO 4027

Order No. steel	Order No. stainless steel	D1	D2	L	T	SW
K0797.03X	K0797.103X	M3	-	5/6/8/10/12/16/20	1,2	1,5
K0797.04X	K0797.104X	M4	-	5/6/8/10/12/16/20/25	1,5	2
K0797.05X	K0797.105X	M5	-	5/6/8/10/12/14/16/20/25/30	2	2,5
K0797.06X	K0797.106X	M6	1,5	6/8/10/12/16/20/25/30/35/40/45/50/60	2	3
K0797.08X	K0797.108X	M8	2	8/10/12/14/16/20/25/30/35/40/45/50/60	3	4
K0797.10X	K0797.110X	M10	2,5	10/12/16/20/25/30/35/40/45/50/60/70/80	4	5