

# Screws with countersunk head

hexagon socket DIN EN ISO 10642

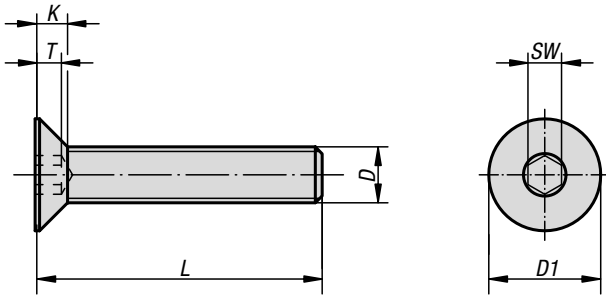

**Material:**

Steel, stainless steel A2 or stainless steel A4.

**Version:**

Steel grade 8.8, bright (black) or electro zinc-plated.  
 Steel grade 10.9, bright (black).  
 Stainless steel A2-70, bright.  
 Stainless steel A4-70, bright.

**Sample order:**

K0708.106X20 (include length L)

## Screws with countersunk head

hexagon socket DIN EN ISO 10642



## KIPP Screws with countersunk head, hexagon socket DIN 7991

Order No. steel Grade 8.8	Order No. steel Grade 10.9	Surface finish body	D	L	D1	K	T	SW
K0708.04X	K0708.304X	bright (black)	M4	10/12/16/20/25	8	2,3	1,8	2,5
K0708.05X	K0708.305X	bright (black)	M5	10/12/16/20/25/30	10	2,8	2,3	3
K0708.06X	K0708.306X	bright (black)	M6	10/12/16/20/25/30/35/40/45/50/60	12	3,3	2,5	4
K0708.08X	K0708.308X	bright (black)	M8	16/20/25/30/35/40/45/50/60	16	4,4	3,5	5
K0708.10X	K0708.310X	bright (black)	M10	16/20/25/30/35/40/45/50/60/70	20	5,5	4,4	6
K0708.12X	K0708.312X	bright (black)	M12	20/25/30/35/40/45/50/60/70/80	24	6,5	4,6	8
K0708.16X	K0708.316X	bright (black)	M16	30/35/40/45/50/60/70/80	30	7,5	5,3	10
K0708.404X	-	galvanised	M4	10/12/16/20/25	8	2,3	1,8	2,5
K0708.405X	-	galvanised	M5	10/12/16/20/25/30	10	2,8	2,3	3
K0708.406X	-	galvanised	M6	10/12/16/20/25/30/35/40/45/50/60	12	3,3	2,5	4
K0708.408X	-	galvanised	M8	16/20/25/30/35/40/45/50/60	16	4,4	3,5	5
K0708.410X	-	galvanised	M10	16/20/25/30/35/40/45/50/60/70	20	5,5	4,4	6
K0708.412X	-	galvanised	M12	20/25/30/35/40/45/50/60/70/80	24	6,5	4,6	8
K0708.416X	-	galvanised	M16	30/35/40/45/50/60/70/80	30	7,5	5,3	10

Order No.	Main material	Surface finish body	D	L	K	T	D1	SW
K0708.104X	stainless steel A2	bright	M4	10/12/16/20/25	2,3	1,8	8	2,5
K0708.105X	stainless steel A2	bright	M5	10/12/16/20/25/30	2,8	2,3	10	3
K0708.106X	stainless steel A2	bright	M6	10/12/16/20/25/30/35/40/45/50/60	3,3	2,5	12	4
K0708.108X	stainless steel A2	bright	M8	16/20/25/30/35/40/45/50/60	4,4	3,5	16	5
K0708.110X	stainless steel A2	bright	M10	16/20/25/30/35/40/45/50/60/70	5,5	4,4	20	6
K0708.112X	stainless steel A2	bright	M12	20/25/30/35/40/45/50/60/70/80	6,5	4,6	24	8
K0708.116X	stainless steel A2	bright	M16	30/35/40/45/50/60/70/80	7,5	5,3	30	10
K0708.604X	stainless steel A4	bright	M4	10/12/16/20/25	2,3	1,8	8	2,5
K0708.605X	stainless steel A4	bright	M5	10/12/16/20/25/30	2,8	2,3	10	3
K0708.606X	stainless steel A4	bright	M6	10/12/16/20/25/30/35/40/45/50/60	3,3	2,5	12	4
K0708.608X	stainless steel A4	bright	M8	16/20/25/30/35/40/45/50/60	4,4	3,5	16	5
K0708.610X	stainless steel A4	bright	M10	16/20/25/30/35/40/45/50/60/70	5,5	4,4	20	6
K0708.612X	stainless steel A4	bright	M12	20/25/30/35/40/45/50/60/70/80	6,5	4,6	24	8
K0708.616X	stainless steel A4	bright	M16	30/35/40/45/50/60/70/80	7,5	5,3	30	10