

Knurled heads

for hexagon socket screws



Material:
Thermoplastic.

Version:
Black, grey or red.

Sample order:
K0680.0506 (knurled head colour red)
Colour code:
5 = grey
6 = red

Note:
Suitable screws ISO 4762.

Δ Add the desired colour code here.
No colour code is required for black.

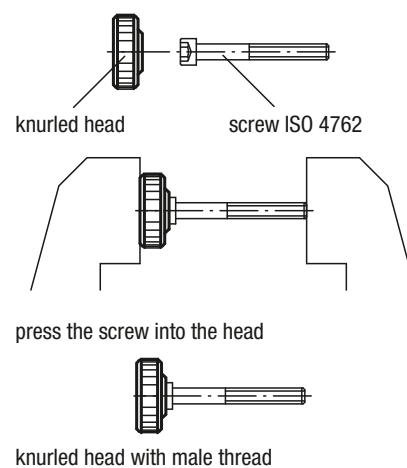
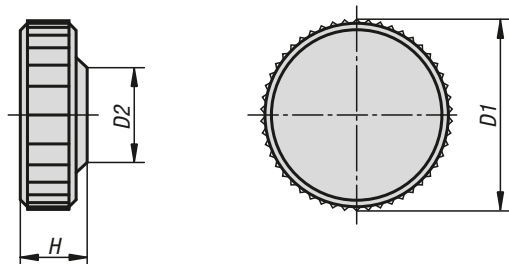

KIPP Knurled heads for hexagon socket screws

| Order No. | D1 | D2 | H | for cap screws |
|------------|-----|------|-----|----------------|
| K0680.030Δ | 9,5 | 8,3 | 4,5 | M3 |
| K0680.040Δ | 13 | 9,6 | 5 | M4 |
| K0680.050Δ | 16 | 11,5 | 6,5 | M5 |
| K0680.060Δ | 19 | 14 | 7,5 | M6 |
| K0680.061Δ | 26 | 13 | 8 | M6 |
| K0680.080Δ | 26 | 16 | 10 | M8 |