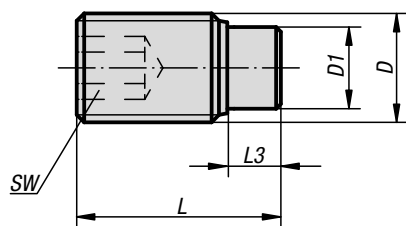

Thrust screws

stainless steel

Material:

Screw stainless steel.
Pin brass or polyacetal.

Version:

Screw bright.

Sample order:

K0667.041X105 (include length L.)

Note:

Thrust screws are ideal for clamping or exerting pressure on threaded spindles, axles, shafts and treated surfaces without marring.

KIPP Thrust screws, stainless steel

Order No.	Component material	D	D1	L	L3	SW
K0667.041X	brass	M4	2,5	6,5/10,5/16,5/30,5/40,5	1,2	2
K0667.051X	brass	M5	3	8,5/12,5/20,5/30,5/40,5	1,3	2,5
K0667.061X	brass	M6	4	11,5/13,5/17,5/21,5/26,5/41,5/51,5/61,5	1,9	3
K0667.081X	brass	M8	5,5	12/22/32/52/62/82	2,4	4
K0667.101X	brass	M10	7	14/18/27/37	2,6	5
K0667.121X	brass	M12	8,5	22,5/32,5/42,5	3,3	6

Order No.	Component material	D	D1	L	L3	SW
K0667.1041X	POM	M4	2	7/9/11/13/17/31/41	1,7	2
K0667.1051X	POM	M5	3	9/11/13/17/21/31/41	1,8	2,5
K0667.1061X	POM	M6	3,5	11,3/13,3/17,3/21,3/26,3/41,3/51,3/61,3	1,7	3
K0667.1081X	POM	M8	5	13,6/17,6/21,6/26,6/33,6/51,6/61,6/81,6	2	4
K0667.1101X	POM	M10	6,5	17,9/21,9/26,9/36,9	2,5	5
K0667.1121X	POM	M12	8	22,1/32,1/42,1	2,9	6