

## Palm grips soft

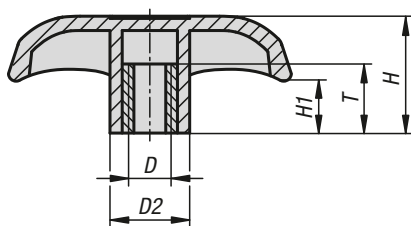

Ⓚ



Ⓛ

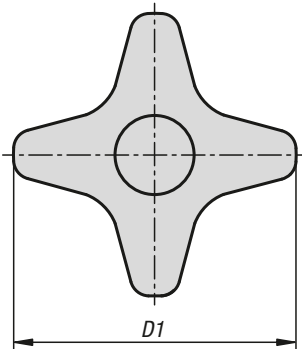
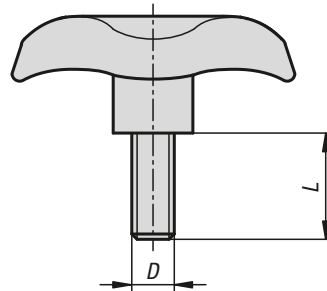

**Material:**

Body hard thermoplastic.  
Coating soft thermoplastic.  
Bush or screw steel 5.8.

**Version:**

Body and coating black.  
Bush and screw electro zinc-plated.

**Sample order:**

K0613.5108X20 (include length L)

**Note:**

Palm grips with a soft gripping surface combine the stability of standard thermoplastic grips with the pleasant feel of the soft surface. The soft coating creates a sympathetic, non-slip surface allowing higher clamping forces while protecting the hand.

### KIPP Palm grips soft with internal thread

Order No.	Form	D	D1	D2	H	H1	T
K0613.5108	K	M8	51	15	22	10	13
K0613.5110	K	M10	51	15	22	10	13
K0613.7608	K	M8	76	19,5	28	13,5	20
K0613.7610	K	M10	76	19,5	28	13,5	20
K0613.7612	K	M12	76	19,5	28	13,5	20

### KIPP Palm grips soft with external thread

Order No.	Form	D	D1	D2	H	H1	L
K0613.5108X	L	M8	51	15	23	10	20/40
K0613.5110X	L	M10	51	15	23	10	20/40
K0613.7608X	L	M8	76	19,5	30	13,5	20/40
K0613.7610X	L	M10	76	19,5	30	13,5	20/40
K0613.7612X	L	M12	76	19,5	30	13,5	20/30/40