

## Magnets shallow pot with internal thread

NdFeB

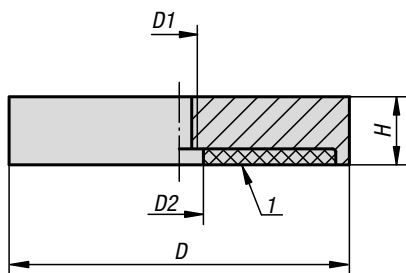

**Material:**  
Housing, steel.  
Magnetic core NdFeB.

**Version:**  
Housing, electro zinc-plated.

**Sample order:**  
K0556.01

**Note:**  
Shielded system

**Temperature range:**  
max. 80°C.

**Drawing reference:**  
1) magnetic face

### KIPP Magnets shallow pot with internal thread NdFeB

Order No.	D	D1	D2	H	Magnetic force N
K0556.01	32	M5	5,5	7	330
K0556.02	40	M5	10,5	8	550
K0556.03	63	M10	11,7	14	1100
K0556.04	75	M10	13	15	1750

# K1394

## Magnets shallow pot with internal thread

hard ferrite

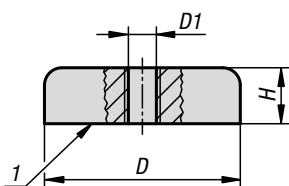

**Material:**  
Housing, steel.  
Magnetic core hard ferrite.

**Version:**  
Housing, electro zinc-plated.

**Sample order:**  
K1394.2504

**Note:**  
Shielded system.

**Temperature range:**  
max. 200°C.

**Drawing reference:**  
1) magnetic face

### KIPP Magnets shallow pot with internal thread, hard ferrite

Order No.	D	D1	H	Magnetic force N
K1394.2504	25 ±0,15	M4	7	36
K1394.3204	32 ±0,2	M4	7	75
K1394.4004	40 ±0,2	M4	8	90
K1394.5006	50 ±0,2	M6	10	170
K1394.5008	50 ±0,2	M8	10	170
K1394.6308	63 ±0,20	M8	14	290
K1394.8008	80 ±0,25	M8	18	550
K1394.8010	80 ±0,25	M10	18	550