

Magnets shallow pot with thread

hard ferrite

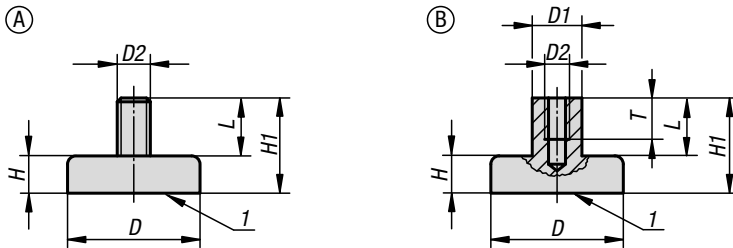

Material:

Housing, steel.
Magnetic core hard ferrite.

Version:

Housing, electro zinc-plated.

Sample order:

K0549.01

Note:

Shallow pot magnets, shielded system.

Hairline cracks in the magnetic material are unavoidable for technical reasons in D=80, D=100 and D=125 versions. They do not impair the attracting function of the magnets in any way.

Temperature range:

max. 200°C.

Drawing reference:

1) magnetic face

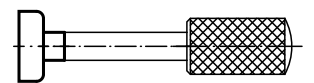

KIPP Magnets shallow pot with thread, hard ferrite

Order No. Form A	Order No. Form B	D	D1	D2	L	H	H1	T	Magnetic force N
K0549.21	K0549.01	10 ±0,15	-6	M3	7	4,5	11,5	-5	4
K0549.22	K0549.02	13 ±0,15	-6	M3	7	4,5	11,5	-5	10
K0549.23	K0549.03	16 ±0,15	-6	M3	7	4,5	11,5	-5	18
K0549.24	K0549.04	20 ±0,15	-6	M3	7	6	13	-5	30
K0549.25	K0549.05	25 ±0,15	-8	M4	8	7	15	-6	40
K0549.26	K0549.06	32 ±0,20	-8	M4	8	7	15	-6	80
-	K0549.07	40 ±0,20	10	M5	10	8	18	8	125
-	K0549.08	50 ±0,20	12	M6	12	10	22	10	220
-	K0549.09	63 ±0,20	15	M8	16	14	30	14	350
-	K0549.10	80 ±0,25	20	M10	16	18	34	14	600
-	K0549.11	99 ±0,25	22	M12	20	22	42	17	900
-	K0549.12	125 ±0,25	25	M14	24	26	50	20	1300