

Magnets deep pot

AlNiCo without fitting tolerance

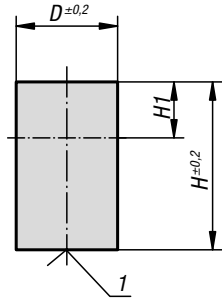

Material:

Housing, steel.
Magnetic core AlNiCo.

Version:

Housing, electro zinc-plated.

Sample order:

K0546.01

Note:

Shielded system. Diameter "D" without fitting tolerance. Fastening possibilities are press-in, shrink-fitting or gluing.
Deep pot magnets can be shortened by the dimension "H1" with no loss of magnetic force.

Temperature range:

max. 450°C.

Drawing reference:

1) magnetic face

KIPP Magnets deep pot AlNiCo without fitting tolerance

| Order No. | D | H | H1 | Magnetic force N |
|-----------|----|----|----|------------------|
| K0546.01 | 6 | 20 | 12 | 1,5 |
| K0546.02 | 8 | 20 | 11 | 3,5 |
| K0546.03 | 10 | 20 | 10 | 7 |
| K0546.04 | 13 | 20 | 9 | 10 |
| K0546.05 | 16 | 20 | 5 | 18 |
| K0546.06 | 20 | 25 | 6 | 42 |
| K0546.07 | 25 | 35 | 10 | 96 |
| K0546.08 | 32 | 40 | 8 | 180 |
| K0546.09 | 40 | 50 | 10 | 240 |