

## Tube end plugs

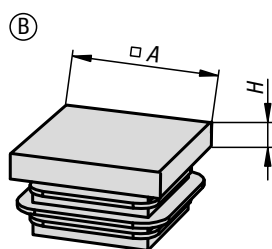
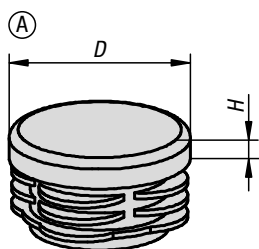

**Material:**  
Polyethylene

**Version:**  
black.

**Sample order:**  
K0494.025200

**Note:**  
These plugs are for corner protection and plugging the tube ends. They can be pushed in by hand or tapped in with a plastic hammer.



### KIPP Tube end plugs

Order No.	Form	Version 2	A	D	H	Suitable for
K0494.018150	A	for round tubes	-	18	5	Ø18x0,8-2
K0494.020200	A	for round tubes	-	20	5	Ø20 x 0,8-2,5
K0494.025200	A	for round tubes	-	25	5	Ø25 x 1-3
K0494.030200	A	for round tubes	-	30	5	Ø30 x 0,8-2,5
K0494.040300	A	for round tubes	-	40	5	Ø40 x 1-3
K0494.040400	A	for round tubes	-	40	5	Ø40 x 3-5
K0494.050400	A	for round tubes	-	50	5	Ø50 x 2,5-4,5
K0494.420100	B	for square tubing	20	-	5	20 x 20 x 0,8-3
K0494.425150	B	for square tubing	25	-	5	25 x 25 x 1-3
K0494.430200	B	for square tubing	30	-	5	30 x 30 x 1-2,5
K0494.440300	B	for square tubing	40	-	5	40 x 40 x 1-3
K0494.440400	B	for square tubing	40	-	5	40 x 40 x 3-5