

## Screw plugs

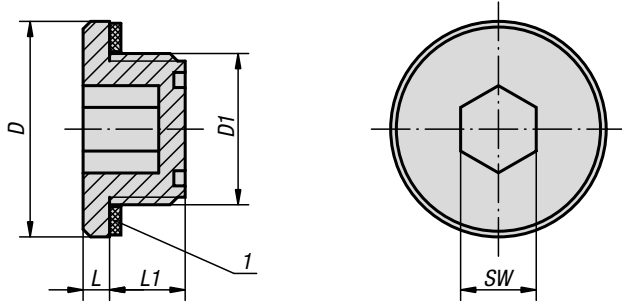

**Material:**

Thermoplastic polyamide 66, reinforced with 30% fibreglass.

**Version:**

Black. Flat seal asbestos-free

**Sample order:**

K0450.22038

**Temperature range:**

Temperature resistant with oil up to 100°C.

**On request:**

O-ring or materials with higher stability.

**Drawing reference:**

1) flat seal

### KIPP Screw plugs

Order No.	D	D1	L	L1	SW	Tightening torque max. Nm
K0450.18014	18,2	G1/4	2,5	8	6	3
K0450.22038	22,5	G3/8	3,5	10,5	8	6
K0450.28012	28,5	G1/2	3,5	10,5	10	8
K0450.35034	35	G3/4	4	10,5	12	10
K0450.201415	20	M14X1,5	2,5	8	6	3
K0450.221615	22,5	M16X1,5	3,5	11	8	6
K0450.261815	26	M18X1,5	3	10	10	7
K0450.282015	28,5	M20X1,5	3	11	10	7
K0450.282215	28,5	M22X1,5	3,5	10,5	10	7
K0450.352615	35	M26X1,5	3	12	12	10

## Press-in plugs

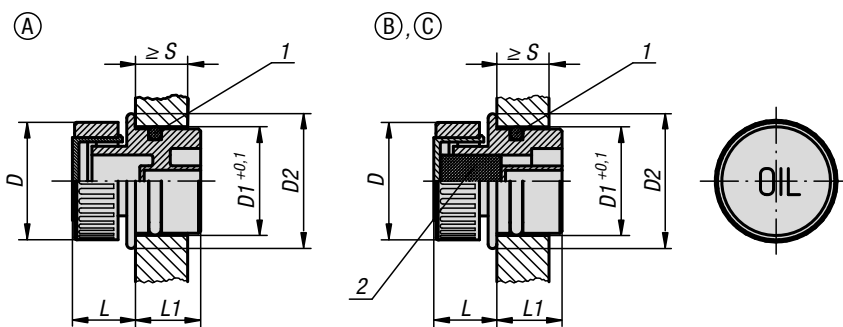

**Material:**

Housing and cap thermoplastic polyamide 66.  
Air filter polyurethane (PU foam).  
O-ring rubber (NBR).

**Version:**

Housing black.  
Cap red.  
Filter mesh 50 µm.

**Sample order:**

K0451.33030

**Temperature range:**

Temperature resistant with oil up to 100°C.

**Drawing reference:**

Form A: without vent  
Form B: with vent  
Form C: with vent and air filter

1) O-ring

2) air filter Form C only

### KIPP Press-in plugs

Order No. Form A	Order No. Form B	Order No. Form C	D	D1	D2	L	L1	S min.
K0451.13018	K0451.23018	K0451.33018	30	18	23	14	14	8
K0451.13020	K0451.23020	K0451.33020	30	20	24	14	15,5	8
K0451.13026	K0451.23026	K0451.33026	30	26	30	14	16,5	9,5
K0451.13030	K0451.23030	K0451.33030	30	30	34	14	17	9,5