

Swivel feet threaded spindles

steel or stainless steel

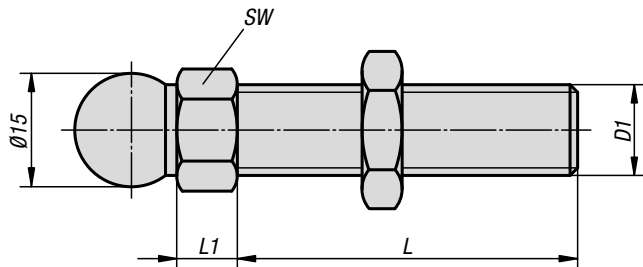

Material:

Steel or 1.4305 stainless steel

Version:

Steel trivalent blue passivated.
Stainless steel, bright.

Sample order:

K0421.060151

K0421.060151 and K0415.1030 **assembled**

Note for ordering:

If the threaded spindle and the plate are to be supplied assembled, please add the suffix **“assembled”** to the order number for the spindle and plate.
(e.g. K0421.060151 and K0415.1030 **assembled**.)

Note:

Swivel feet consist of a threaded spindle and a plate joined together. Any threaded spindle can be combined with any plate.

The height of the complete swivel foot can be calculated from the length of the threaded spindle + height of hexagon + 22.5 mm.

(Overall height of swivel foot = L + L1 + 22.5 mm)

Depending on the version, threaded spindles can have a thread undercut in front of the hexagon.

KIPP Swivel feet threaded spindles

Order No. steel	Order No. stainless steel	D1	L	L1	SW	Load rating max. kN
K0421.060151	K0421.060152	M6	15	7,5	14	2
K0421.060301	K0421.060302	M6	30	7,5	14	2
K0421.080401	K0421.080402	M8	40	7,5	14	3,5
K0421.080801	K0421.080802	M8	80	7,5	14	3,5
K0421.100451	K0421.100452	M10	45	7,5	14	4,7
K0421.100701	K0421.100702	M10	70	7,5	14	4,7
K0421.100901	K0421.100902	M10	90	7,5	14	4,7
K0421.101251	K0421.101252	M10	125	7,5	14	4,7
K0421.101501	K0421.101502	M10	150	7,5	14	4,7
K0421.120451	K0421.120452	M12	45	7,5	14	7,7
K0421.120661	K0421.120662	M12	66	7,5	14	7,7
K0421.121001	K0421.121002	M12	100	7,5	14	7,7
K0421.121251	K0421.121252	M12	125	7,5	14	7,7
K0421.121501	K0421.121502	M12	150	7,5	14	7,7
K0421.140661	K0421.140662	M14	66	7,5	14	11,1
K0421.141001	K0421.141002	M14	100	7,5	14	11,1
K0421.141251	K0421.141252	M14	125	7,5	14	11,1
K0421.141501	K0421.141502	M14	150	7,5	14	11,1
K0421.160661	K0421.160662	M16	66	7,5	17	14,5
K0421.161001	K0421.161002	M16	100	7,5	17	14,5
K0421.161251	K0421.161252	M16	125	7,5	17	14,5
K0421.161501	K0421.161502	M16	150	7,5	17	14,5
K0421.162001	K0421.162002	M16	200	7,5	17	14,5
K0421.200851	K0421.200852	M20	85	10,5	22	24,3
K0421.201001	K0421.201002	M20	100	10,5	22	24,3
K0421.201251	K0421.201252	M20	125	10,5	22	24,3
K0421.201501	K0421.201502	M20	150	10,5	22	24,3
K0421.202001	K0421.202002	M20	200	10,5	22	24,3
K0421.240851	K0421.240852	M24	85	10,5	24	36,1
K0421.241001	K0421.241002	M24	100	10,5	24	36,1
K0421.241251	K0421.241252	M24	125	10,5	24	36,1
K0421.241501	K0421.241502	M24	150	10,5	24	36,1
K0421.242001	K0421.242002	M24	200	10,5	24	36,1

