

## Thrust pads

DIN 6311 enhanced

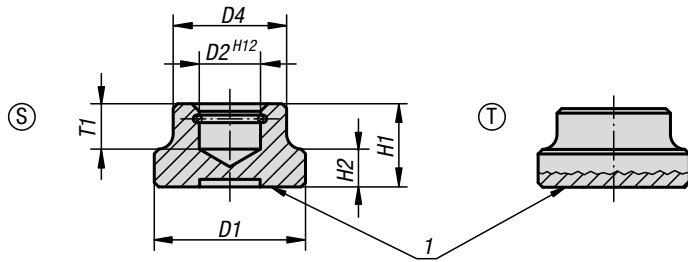

**Material:**

Steel: case-hardened. Snap ring spring steel.  
Stainless steel: bright. Snap ring stainless steel.

**Version:**

Steel black oxidised.  
Stainless steel bright.

**Sample order:**

K0392.12

**Note:**

To press onto a thrust point, incline the point as far as possible over the snap ring opening and twist in. The snap ring is supplied assembled.

**Drawing reference:**

Form S: standard thrust pad  
Form T: low version, large thrust face

1) thrust face

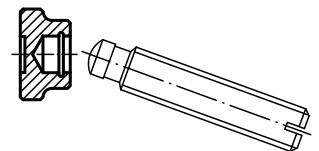

### KIPP Thrust pads DIN 6311 enhanced

Order No. steel	Order No. stainless steel	Form	D1	D2	D4	H1	H2	T1	For grub screws with trust point DIN 6332
K0392.06	K0392.061	S	12	4,6	10	7	2,5	4	M6
K0392.08	K0392.081	S	16	6,1	12	9	4	5	M8
K0392.10	K0392.101	S	20	8,1	15	11	5	6	M10
K0392.12	K0392.121	S	25	8,1	18	13	7	7	M12
K0392.16	K0392.161	S	32	12,1	22	15	7	7,5	M16
K0392.20	K0392.201	S	40	15,6	28	16	9	8	M20
K0392.108	-	T	25	6,1	12	8	4	4,5	M8
K0392.110	-	T	32	8,1	18	10	6	6	M10 / M12
K0392.116	-	T	40	12,1	22	12	7	7	M16