

## Grub screws

with thrust point DIN 6332

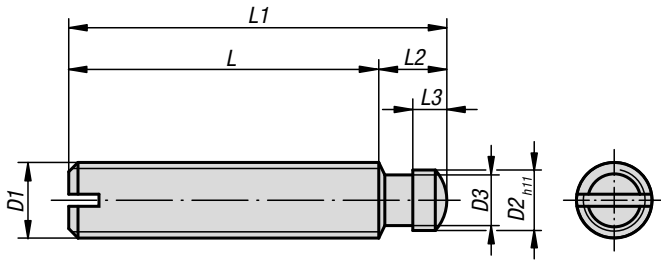

**Material:**

Steel or stainless steel.

**Version:**

Steel: thrust point case-hardened, black.

Stainless steel: bright.

**Sample order:**

K0390.12X60 (include length L1.)

**Note:**

The thrust journal of the grub screws per DIN 6332 is designed for direct clamping as well as for use in conjunction with a thrust pad K0392.

**Drawing reference:**

1) snap ring

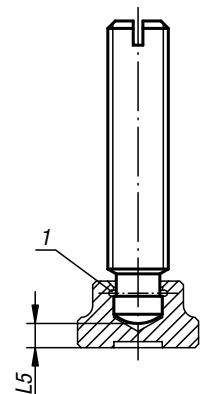

### KIPP Grub screws with thrust point DIN 6332

Order No. steel	Order No. stainless steel	D1	L1	D2	D3	L	L2	L3	L5
K0390.06X	K0390.061X	M6	30/35/40/50	4,5	4	24	6	2,5	2,2
K0390.08X	K0390.081X	M8	35/40/45/50/60	6	5,4	27,5	7,5	3	3
K0390.10X	K0390.101X	M10	50/55/60/65/80	8	7,2	41	9	4,5	3,6
K0390.12X	K0390.121X	M12	60/65/70/80/100	8	7,2	50	10	4,5	4,5
K0390.14X	K0390.141X	M14	60/80/100	10	9	48	12	5	5
K0390.16X	K0390.161X	M16	65/70/80/100/125	12	11	53	12	5	5,3
K0390.20X	K0390.201X	M20	80/90/100/125/150	15,5	14,4	66	14	5,5	5,6