

Thrust screws

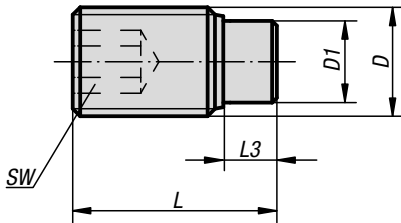

Material:

Screw grade 10.9.
Thrust pin brass or polyacetal.

Version:

Screw black oxidised.

Sample order:

K0389.04X105 (include length L.)

Note:

Thrust screws are ideal for clamping or exerting pressure on threaded spindles, axles, shafts and treated surfaces without marring.

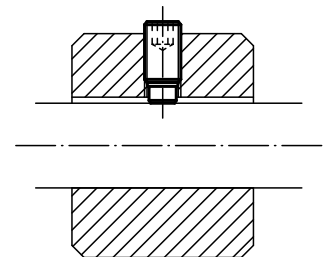

KIPP Thrust screws

Order No.	Component material	D	D1	L	L3	SW
K0389.04X	brass	M4	2,5	6,5/10,5/16,5/30,5/40,5	1,2	2
K0389.05X	brass	M5	3	12,5/20,5/30,5/40,5/8,5	1,3	2,5
K0389.06X	brass	M6	4	11,5/17,5/26,5/41,5/51,5/61,5	1,9	3
K0389.08X	brass	M8	5,5	12/22/32/52/62/82	2,4	4
K0389.10X	brass	M10	7	14/18/27/37/52/62/82	2,6	5
K0389.12X	brass	M12	8,5	18,5/22,5/32,5/42,5/52,5/62,5/82,5	3,3	6

Order No.	Component material	D	D1	L	L3	SW
K0389.104X	POM	M4	2	11/13/17/31/41/7/9	1,7	2
K0389.105X	POM	M5	3	11/13/17/21/31/41/9	1,8	2,5
K0389.106X	POM	M6	3,5	11,3/13,3/17,3/21,3/26,3/41,3/51,3/61,3	1,7	3
K0389.108X	POM	M8	5	13,6/17,6/21,6/26,6/33,6/51,6/61,6/81,6	2	4
K0389.110X	POM	M10	6,5	17,9/21,9/26,9/33,9/41,9/51,9/61,9/81,9	2,5	5
K0389.112X	POM	M12	8	22,1/27,1/34,1/42,1/52,1/62,1/82,1	2,9	6