

Ball-end thrust screws without head

stainless steel with full ball

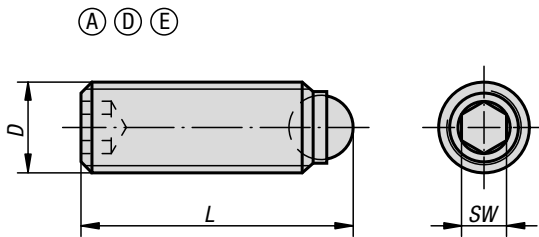

Material:

Screw stainless steel.

Ball stainless steel, POM or ceramic Si_3N_4 .

Version:

Stainless steel bright.

Sample order:

K0384.1046

Note:

Ball-end thrust screws with full ball are used when a clean, polished contact surface is required. Longer versions have been designed especially to be glued in, allowing mechanical connecting elements with external threads to be made cost-effectively for small and medium-sized runs. Silicon nitride (Si_3N_4) is characterised by a combination of excellent properties, these include high resilience and strength, excellent wear resistance and good chemical resistance.

Drawing reference:

Form A: stainless steel ball

Form D: POM ball

Form E: ceramic ball

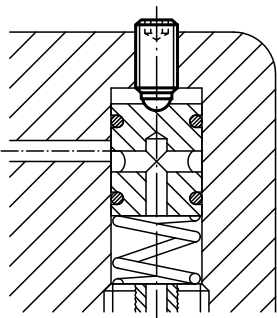

Ball-end thrust screws without head

stainless steel with full ball

KIPP Ball-end thrust screws without head, stainless steel, with full ball

Order No. Form A	Order No. Form D	Order No. Form E	D	L	Ball-Ø	SW	Load rating max. kN (static load only)
K0384.10412	K0384.30412	-	M4	12	2,5	2	-/0,3
K0384.10416	K0384.30416	-	M4	16	2,5	2	-/0,3
K0384.1046	K0384.3046	-	M4	6	2,5	2	-/0,3
K0384.1048	K0384.3048	-	M4	8	2,5	2	-/0,3
K0384.10510	K0384.30510	-	M5	10	3	2,5	-/0,5/4,5
K0384.10512	K0384.30512	K0384.80512	M5	12	3	2,5	-/0,5/4,5
K0384.10516	K0384.30516	-	M5	16	3	2,5	-/0,5/4,5
K0384.10520	K0384.30520	K0384.80520	M5	20	3	2,5	-/0,5/4,5
K0384.10525	K0384.30525	-	M5	25	3	2,5	-/0,5/4,5
K0384.1058	K0384.3058	K0384.8058	M5	8	3	2,5	-/0,5/4,5
K0384.10610	K0384.30610	K0384.80610	M6	10,8	4	3	-/0,9/9
K0384.10612	K0384.30612	-	M6	12,8	4	3	-/0,9/9
K0384.10616	K0384.30616	K0384.80616	M6	16,8	4	3	-/0,9/9
K0384.10620	K0384.30620	K0384.80620	M6	20,8	4	3	-/0,9/9
K0384.10625	K0384.30625	K0384.80625	M6	25,8	4	3	-/0,9/9
K0384.10650	-	-	M6	50,8	4	3	-/0,9/9
K0384.10660	-	-	M6	60,8	4	3	-/0,9/9
K0384.10680	-	-	M6	80,8	4	3	-/0,9/9
K0384.10810	K0384.30810	K0384.80810	M8	11,2	5,5	4	-/1,5/10/15
K0384.10812	K0384.30812	K0384.80812	M8	13,2	5,5	4	-/1,5/10/15
K0384.10816	K0384.30816	-	M8	17,2	5,5	4	-/1,5/10/15
K0384.10820	K0384.30820	K0384.80820	M8	21,2	5,5	4	-/1,5/10/15
K0384.10825	K0384.30825	K0384.80825	M8	26,2	5,5	4	-/1,5/10/15
K0384.10830	K0384.30830	K0384.80830	M8	31,2	5,5	4	-/1,5/10/15
K0384.10850	-	-	M8	51,2	5,5	4	-/1,5/10/15
K0384.10860	-	-	M8	61,2	5,5	4	-/1,5/10/15
K0384.10880	-	-	M8	81,2	5,5	4	-/1,5/10/15
K0384.11012	-	K0384.81012	M10	13,7	7	5	-/20
K0384.11016	-	K0384.81016	M10	17,7	7	5	-/20
K0384.11020	-	K0384.81020	M10	21,7	7	5	-/20
K0384.11025	-	K0384.81025	M10	26,7	7	5	-/20
K0384.11035	-	K0384.81035	M10	36,7	7	5	-/20
K0384.11216	-	K0384.81216	M12	18	8,5	6	-/30
K0384.11220	-	K0384.81220	M12	22	8,5	6	-/30
K0384.11225	-	-	M12	27	8,5	6	-/30
K0384.11230	-	K0384.81230	M12	32	8,5	6	-/30
K0384.11232	-	-	M12	34	8,5	6	-/30
K0384.11240	-	K0384.81240	M12	42	8,5	6	-/30
K0384.11620	-	-	M16	23,3	12	8	-
K0384.11625	-	-	M16	28,3	12	8	-
K0384.11635	-	-	M16	38,3	12	8	-
K0384.10410	K0384.30410	-	M4	10	2,5	2	-/0,3
K0384.11650	-	-	M16	53,3	12	8	-

Ball-end thrust screws without head

stainless steel with flattened ball

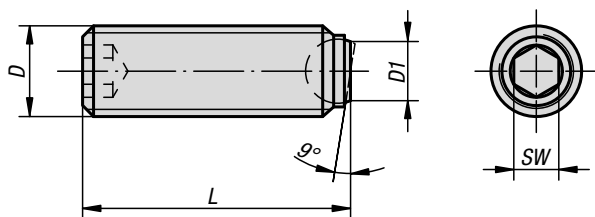

KIPP Ball-end thrust screws without head, stainless steel with flattened ball

Order No.	Form	D	D1	L	Ball-Ø	SW
K0384.2046	B	M4	1,4	5,8	2,5	2
K0384.2048	B	M4	1,4	7,8	2,5	2
K0384.20410	B	M4	1,4	9,8	2,5	2
K0384.20412	B	M4	1,4	11,8	2,5	2
K0384.20416	B	M4	1,4	15,8	2,5	2
K0384.2058	B	M5	2	7,6	3	2,5
K0384.20510	B	M5	2	9,6	3	2,5
K0384.20512	B	M5	2	11,6	3	2,5
K0384.20516	B	M5	2	15,6	3	2,5
K0384.20520	B	M5	2	19,6	3	2,5
K0384.20525	B	M5	2	24,6	3	2,5
K0384.20610	B	M6	3	10,1	4	3
K0384.20612	B	M6	3	12,1	4	3
K0384.20616	B	M6	3	16,1	4	3
K0384.20620	B	M6	3	20,1	4	3
K0384.20625	B	M6	3	25,1	4	3
K0384.20650	B	M6	3	50,1	4	3
K0384.20660	B	M6	3	60,1	4	3
K0384.20680	B	M6	3	80,1	4	3
K0384.20810	B	M8	4,1	10,3	5,5	4
K0384.20812	B	M8	4,1	12,3	5,5	4
K0384.20816	B	M8	4,1	16,3	5,5	4
K0384.20820	B	M8	4,1	20,3	5,5	4
K0384.20825	B	M8	4,1	25,3	5,5	4
K0384.20830	B	M8	4,1	30,3	5,5	4
K0384.20850	B	M8	4,1	50,3	5,5	4
K0384.20860	B	M8	4,1	60,3	5,5	4
K0384.20880	B	M8	4,1	80,3	5,5	4
K0384.21012	B	M10	5,6	12,3	7	5
K0384.21016	B	M10	5,6	16,3	7	5
K0384.21020	B	M10	5,6	20,3	7	5
K0384.21025	B	M10	5,6	25,3	7	5
K0384.21035	B	M10	5,6	35,3	7	5
K0384.21216	B	M12	7	16,2	8,5	6
K0384.21220	B	M12	7	20,2	8,5	6
K0384.21230	B	M12	7	30,2	8,5	6
K0384.21240	B	M12	7	40,2	8,5	6
K0384.21620	B	M16	10,7	20	12	8
K0384.21625	B	M16	10,7	25	12	8
K0384.21635	B	M16	10,7	35	12	8
K0384.21650	B	M16	10,7	50	12	8

Material:

Screw and ball stainless steel.

Version:

Stainless steel bright.

Sample order:

K0384.2046

Note:

Surfaces which are not flat and parallel can be firmly clamped or supported with a flattened ball, the movable ball can adapt itself up to 9°.

Longer versions have been designed especially to be glued in. This enables mechanical connecting elements with male thread to be made cost-effectively for small and medium-sized series.

Ball-end thrust screws without head

stainless steel with flattened ball and rotation lock



Material:

Screw and ball stainless steel.

Version:

Stainless steel bright.

Sample order:

K0384.50612

Note:

Surfaces which are not flat and parallel can be firmly clamped or supported with a flattened ball, the movable ball can adapt itself up to 9°.

Longer versions have been designed especially to be glued in. This enables mechanical connecting elements with male thread to be made cost-effectively for small and medium-sized series. Surfaces which are not flat and parallel can be firmly clamped or supported with a flattened ball, the movable ball can adapt itself up to 9°.

Longer versions have been designed especially to be glued in. This enables mechanical connecting elements with male thread to be made cost-effectively for small and medium-sized series.

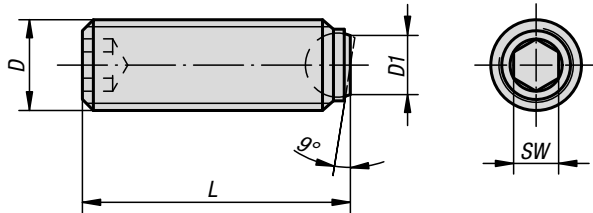

KIPP Ball-end thrust screws without head stainless steel with flattened ball and rotation lock

Order No.	Form	D	D1	L	Ball-Ø	SW
K0384.50612	BV	M6	3	12,1	4	3
K0384.50616	BV	M6	3	16,1	4	3
K0384.50620	BV	M6	3	20,1	4	3
K0384.50625	BV	M6	3	25,1	4	3
K0384.50816	BV	M8	4,1	16,3	5,5	4
K0384.50820	BV	M8	4,1	20,3	5,5	4
K0384.50825	BV	M8	4,1	25,3	5,5	4
K0384.50830	BV	M8	4,1	30,3	5,5	4
K0384.51020	BV	M10	5,6	20,3	7	5
K0384.51025	BV	M10	5,6	25,3	7	5
K0384.51035	BV	M10	5,6	35,3	7	5
K0384.51040	BV	M10	5,6	40,2	7	5
K0384.51220	BV	M12	7	20,2	8,5	6
K0384.51230	BV	M12	7	30,2	8,5	6
K0384.51240	BV	M12	7	40,2	8,5	6
K0384.51250	BV	M12	7	50	8,5	6
K0384.51635	BV	M16	10,7	35	12	8
K0384.51650	BV	M16	10,7	50	12	8