

Ball-end thrust screws without head

with fine thread

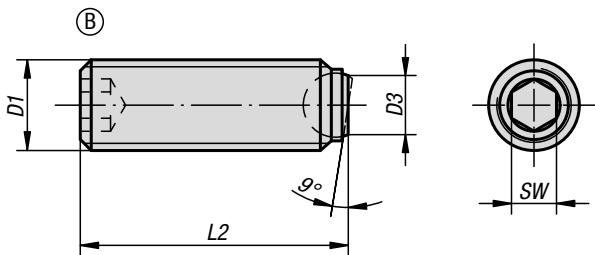
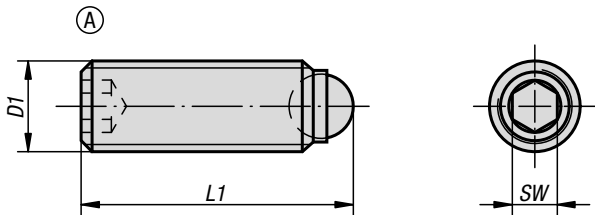

Material:

Screw high-carbon steel, grade 10.9.
Ball, ball-bearing steel.

Version:

Screw black.
Ball hardened and bright.

Sample order:

K0382.11025

Note:

Form A with full ball is used when a clean, polished pressure surface is required. Surfaces which are not plane and parallel can be firmly clamped or supported with Form B with flattened ball because the movable ball can adapt itself up to 9°.

Fine thread enables extremely sensitive alignment of the ball-end thrust screws.

Drawing reference:

Form A: with full ball
Form B: with flattened ball

KIPP Ball-end thrust screws without head with fine thread

Order No. Form A	Order No. Form B	D1	D3	L1	L2	Ball Ø	SW	Load rating max. kN (static load only)
K0382.10810	K0382.20810	M8x1	-/4,1	11,2/-	-/10,3	5,5	4	10
K0382.10820	K0382.20820	M8x1	-/4,1	21,2/-	-/20,3	5,5	4	15
K0382.11012	K0382.21012	M10x1	-/5,6	13,7/-	-/12,3	7	5	20
K0382.11025	K0382.21025	M10x1	-/5,6	26,7/-	-/25,3	7	5	20
K0382.11216	K0382.21216	M12x1,5	-/7	18/-	-/16,2	8,5	6	30
K0382.11230	K0382.21230	M12x1,5	-/7	32/-	-/30,2	8,5	6	30
K0382.11620	K0382.21620	M16x1,5	-/10,7	23,3/-	-/20	12	8	60
K0382.11635	K0382.21635	M16x1,5	-/10,7	38,3/-	-/35	12	8	60
K0382.12030	K0382.22030	M20x1,5	-/13,5	34,2/-	-/30	15	10	90
K0382.12040	K0382.22040	M20x1,5	-/13,5	44,2/-	-/40	15	10	90