

Lateral spring plungers

without thrust pin

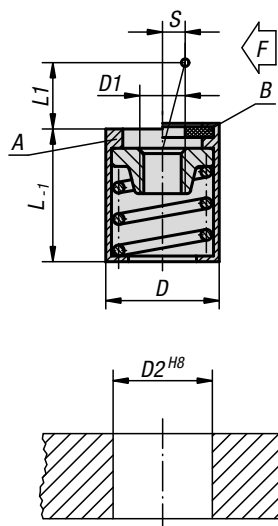

Material:

Sleeve aluminium.
Receiving washer steel.
Spring steel.

Version:

Sleeve blue electro zinc-plated.
Washer, hardened and burnished.

Sample order:

K0370.31058

Note:

The thrust pin can be made to suit the required circumstances and screwed into the tapped hole in the locating washer.

The required lateral thrust (F) can be achieved through the stroke (S) and length (L1).

Form B has a seal to keep swarf and dirt out.

KIPP Lateral spring plungers without thrust pin, Form A, without seal

Order No.	Form	D	D1	D2	L	L1	S	F ca.N
K0370.31054	A	10	M4	10	12	4	1,6	20
K0370.31056	A	10	M4	10	12	4	1,6	50
K0370.31058	A	10	M4	10	12	4	1,6	100
K0370.31064	A	10	M4	10	12	7,5	2	40
K0370.31066	A	10	M4	10	12	7,5	2	75
K0370.31068	A	10	M4	10	12	7,5	2	100
K0370.31104	A	16	M6	16	18	11,5	3,2	100
K0370.31106	A	16	M6	16	18	11,5	3,2	150
K0370.31108	A	16	M6	16	18	11,5	3,2	200

KIPP Lateral spring plungers without thrust pins, Form B, with seal

Order No.	Form	D	D1	D2	L	L1	S	F ca.N
K0370.32054	B	10	M4	10	12	4	1,6	20
K0370.32056	B	10	M4	10	12	4	1,6	50
K0370.32058	B	10	M4	10	12	4	1,6	100
K0370.32064	B	10	M4	10	12	7,5	2	40
K0370.32066	B	10	M4	10	12	7,5	2	75
K0370.32068	B	10	M4	10	12	7,5	2	100
K0370.32104	B	16	M6	16	18	11,5	3,2	100
K0370.32106	B	16	M6	16	18	11,5	3,2	150
K0370.32108	B	16	M6	16	18	11,5	3,2	200