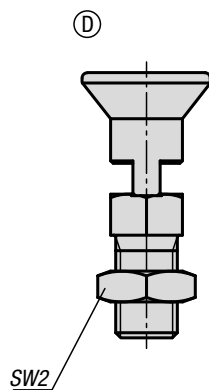
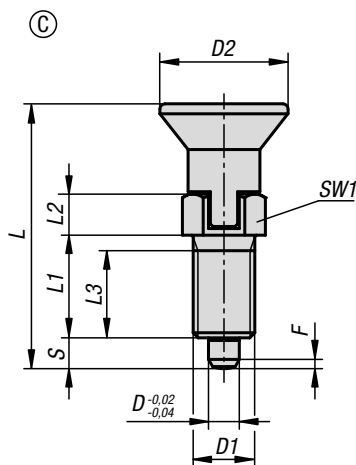
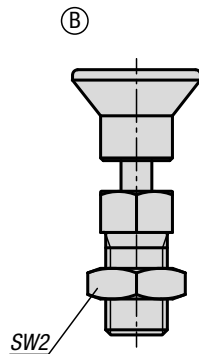
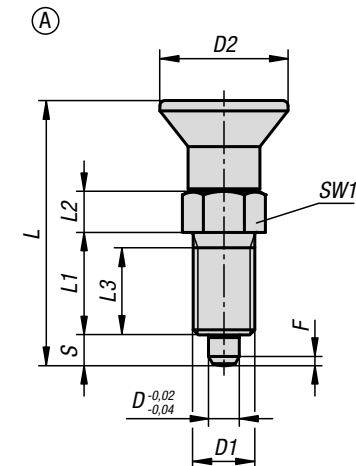

## Indexing plungers steel or stainless steel

**Drawing reference:**

- Form A: non-lockout type, without locknut
- Form B: non-lockout type, with locknut
- Form C: lockout type, without locknut
- Form D: lockout type, with locknut

Indexing plungers are used where it is necessary to prevent changes of position due to lateral forces. Some examples of this are for length, height and position indexing in machines, equipment, furniture and special vehicle construction.

A new indexed position can only be moved to after the pin has been manually retracted. Form C and D are recommended for applications where the indexing pin should remain disengaged for an extended period and be prevented from springing back.

The materials used enable diverse applications including those with the highest demands on corrosion resistance

**Material:**

Steel version:

Threaded sleeve and indexing pin free-cutting steel.  
Spring 1.4310.

Stainless steel version A2:

Threaded sleeve 1.4305.  
Hardened indexing pin 1.4034.  
Not hardened indexing pin 1.4305.  
Spring 1.4310.

Stainless steel version A4:

Threaded sleeve and indexing pin 1.4404.  
Spring 1.4401 or 1.4571.

Mushroom grip thermoplastic, dark grey or traffic red RAL3020.

**Version:**

Steel version:

Threaded sleeve, black oxidised.  
Indexing pin hardened, ground and black oxidised.

Stainless steel A2 version:

threaded sleeve bright.  
Indexing pin hardened or not hardened, ground and bright.

Stainless steel A4 version:

threaded sleeve bright.  
Indexing pin ground, chemically nickel-plated or bright.

**Sample order:**

K0338.04206

**On request:**

Special versions.

**Accessories:**

Spacer rings K0665

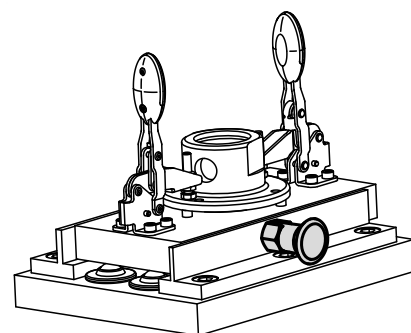

## KIPP Indexing plungers, steel, indexing pin hardened

Order No. Form A	Order No. Form B	Order No. Form C	Order No. Form D	Component colour	D	D1	D2	L	L1	L2	L3	Travel S	SW1	SW2	Fx30°	Spring force initial pressure F1 approx. N	Spring force final pressure F2 approx. N
K0338.1903	K0338.2903	K0338.3903	K0338.4903	black grey RAL 7021	3	M6x0,75	14	31,5	12	5	10	3,5	8	-/10/-/10	0,8	4,5	10
K0338.1004	K0338.2004	K0338.3004	K0338.4004	black grey RAL 7021	4	M8x1	18	38,5	15	6	13	4	10	-/13/-/13	1	6	12
K0338.1105	K0338.2105	K0338.3105	K0338.4105	black grey RAL 7021	5	M10x1	21	43,5	17	7	15	5	13	-/17/-/17	1,3	5	12
K0338.1206	K0338.2206	K0338.3206	K0338.4206	black grey RAL 7021	6	M12x1,5	25	51,7	20	8	17	6	14	-/19/-/19	1,8	6	14
K0338.1308	K0338.2308	K0338.3308	K0338.4308	black grey RAL 7021	8	M16x1,5	33	68	26	10	23	8	19	-/24/-/24	2,3	15	35
K0338.1410	K0338.2410	K0338.3410	K0338.4410	black grey RAL 7021	10	M20x1,5	33	74	28	12	25	10	22	-/30/-/30	2,8	15	34
K0338.1412	K0338.2412	K0338.3412	K0338.4412	black grey RAL 7021	12	M20x1,5	33	78	28	14	25	12	22	-/30/-/30	2,8	15	39
K0338.1516	K0338.2516	K0338.3516	K0338.4516	black grey RAL 7021	16	M24x2	40	96	32	18	28	16	27	-/36/-/36	3,2	20	46
K0338.190384	K0338.290384	K0338.390384	K0338.490384	traffic red RAL 3020	3	M6x0,75	14	31,5	12	5	10	3,5	8	-/10/-/10	0,8	4,5	10
K0338.100484	K0338.200484	K0338.300484	K0338.400484	traffic red RAL 3020	4	M8x1	18	38,5	15	6	13	4	10	-/13/-/13	1	6	12
K0338.110584	K0338.210584	K0338.310584	K0338.410584	traffic red RAL 3020	5	M10x1	21	43,5	17	7	15	5	13	-/17/-/17	1,3	5	12
K0338.120684	K0338.220684	K0338.320684	K0338.420684	traffic red RAL 3020	6	M12x1,5	25	51,7	20	8	17	6	14	-/19/-/19	1,8	6	14
K0338.130884	K0338.230884	K0338.330884	K0338.430884	traffic red RAL 3020	8	M16x1,5	33	68	26	10	23	8	19	-/24/-/24	2,3	15	35
K0338.141084	K0338.241084	K0338.341084	K0338.441084	traffic red RAL 3020	10	M20x1,5	33	74	28	12	25	10	22	-/30/-/30	2,8	15	34
K0338.141284	K0338.241284	K0338.341284	K0338.441284	traffic red RAL 3020	12	M20x1,5	33	78	28	14	25	12	22	-/30/-/30	2,8	15	39
K0338.151684	K0338.251684	K0338.351684	K0338.451684	traffic red RAL 3020	16	M24x2	40	96	32	18	28	16	27	-/36/-/36	3,2	20	46

## Indexing plungers steel or stainless steel



## KIPP Indexing plungers, stainless steel A2, indexing pin hardened

Order No. Form A	Order No. Form B	Order No. Form C	Order No. Form D	Component colour	D	D1	D2	L	L1	L2	L3	Travel S	SW1	SW2	Fx30°	Spring force initial pressure F1 approx. N	Spring force final pressure F2 approx. N
K0338.01903	K0338.02903	K0338.03903	K0338.04903	black grey RAL 7021	3	M6x0,75	14	31,5	12	5	10	3,5	8	-/10-/10	0,8	4,5	10
K0338.01004	K0338.02004	K0338.03004	K0338.04004	black grey RAL 7021	4	M8x1	18	38,5	15	6	13	4	10	-/13-/13	1	6	12
K0338.01105	K0338.02105	K0338.03105	K0338.04105	black grey RAL 7021	5	M10x1	21	43,5	17	7	15	5	13	-/17-/17	1,3	5	12
K0338.01206	K0338.02206	K0338.03206	K0338.04206	black grey RAL 7021	6	M12x1,5	25	51,7	20	8	17	6	14	-/19-/19	1,8	6	14
K0338.01308	K0338.02308	K0338.03308	K0338.04308	black grey RAL 7021	8	M16x1,5	33	68	26	10	23	8	19	-/24-/24	2,3	15	35
K0338.01410	K0338.02410	K0338.03410	K0338.04410	black grey RAL 7021	10	M20x1,5	33	74	28	12	25	10	22	-/30-/30	2,8	15	34
K0338.01412	K0338.02412	K0338.03412	K0338.04412	black grey RAL 7021	12	M20x1,5	33	78	28	14	25	12	22	-/30-/30	2,8	15	39
K0338.01516	K0338.02516	K0338.03516	K0338.04516	black grey RAL 7021	16	M24x2	40	96	32	18	28	16	27	-/36-/36	3,2	20	46
K0338.0190384	K0338.0290384	K0338.0390384	K0338.0490384	traffic red RAL 3020	3	M6x0,75	14	31,5	12	5	10	3,5	8	-/10-/10	0,8	4,5	10
K0338.0100484	K0338.0200484	K0338.0300484	K0338.0400484	traffic red RAL 3020	4	M8x1	18	38,5	15	6	13	4	10	-/13-/13	1	6	12
K0338.0110584	K0338.0210584	K0338.0310584	K0338.0410584	traffic red RAL 3020	5	M10x1	21	43,5	17	7	15	5	13	-/17-/17	1,3	5	12
K0338.0120684	K0338.0220684	K0338.0320684	K0338.0420684	traffic red RAL 3020	6	M12x1,5	25	51,7	20	8	17	6	14	-/19-/19	1,8	6	14
K0338.0130884	K0338.0230884	K0338.0330884	K0338.0430884	traffic red RAL 3020	8	M16x1,5	33	68	26	10	23	8	19	-/24-/24	2,3	15	35
K0338.0141084	K0338.0241084	K0338.0341084	K0338.0441084	traffic red RAL 3020	10	M20x1,5	33	74	28	12	25	10	22	-/30-/30	2,8	15	34
K0338.0141284	K0338.0241284	K0338.0341284	K0338.0441284	traffic red RAL 3020	12	M20x1,5	33	78	28	14	25	12	22	-/30-/30	2,8	15	39
K0338.0151684	K0338.0251684	K0338.0351684	K0338.0451684	traffic red RAL 3020	16	M24x2	40	96	32	18	28	16	27	-/36-/36	3,2	20	46

## KIPP Indexing plungers, stainless steel A2, indexing pin not hardened

Order No. Form A	Order No. Form B	Order No. Form C	Order No. Form D	Component colour	D	D1	D2	L	L1	L2	L3	Travel S	SW1	SW2	Fx30°	Spring force initial pressure F1 approx. N	Spring force final pressure F2 approx. N
K0338.11903	K0338.12903	K0338.13903	K0338.14903	black grey RAL 7021	3	M6x0,75	14	31,5	12	5	10	3,5	8	-/10-/10	0,8	4,5	10
K0338.11004	K0338.12004	K0338.13004	K0338.14004	black grey RAL 7021	4	M8x1	18	38,5	15	6	13	4	10	-/13-/13	1	6	12
K0338.11105	K0338.12105	K0338.13105	K0338.14105	black grey RAL 7021	5	M10x1	21	43,5	17	7	15	5	13	-/17-/17	1,3	5	12
K0338.11206	K0338.12206	K0338.13206	K0338.14206	black grey RAL 7021	6	M12x1,5	25	51,7	20	8	17	6	14	-/19-/19	1,8	6	14
K0338.11308	K0338.12308	K0338.13308	K0338.14308	black grey RAL 7021	8	M16x1,5	33	68	26	10	23	8	19	-/24-/24	2,3	15	35
K0338.11410	K0338.12410	K0338.13410	K0338.14410	black grey RAL 7021	10	M20x1,5	33	74	28	12	25	10	22	-/30-/30	2,8	15	34
K0338.11412	K0338.12412	K0338.13412	K0338.14412	black grey RAL 7021	12	M20x1,5	33	78	28	14	25	12	22	-/30-/30	2,8	15	39
K0338.11516	K0338.12516	K0338.13516	K0338.14516	black grey RAL 7021	16	M24x2	40	96	32	18	28	16	27	-/36-/36	3,2	20	46
K0338.1190384	K0338.1290384	K0338.1390384	K0338.1490384	traffic red RAL 3020	3	M6x0,75	14	31,5	12	5	10	3,5	8	-/10-/10	0,8	4,5	10
K0338.1100484	K0338.1200484	K0338.1300484	K0338.1400484	traffic red RAL 3020	4	M8x1	18	38,5	15	6	13	4	10	-/13-/13	1	6	12
K0338.1110584	K0338.1210584	K0338.1310584	K0338.1410584	traffic red RAL 3020	5	M10x1	21	43,5	17	7	15	5	13	-/17-/17	1,3	5	12
K0338.1120684	K0338.1220684	K0338.1320684	K0338.1420684	traffic red RAL 3020	6	M12x1,5	25	51,7	20	8	17	6	14	-/19-/19	1,8	6	14
K0338.1130884	K0338.1230884	K0338.1330884	K0338.1430884	traffic red RAL 3020	8	M16x1,5	33	68	26	10	23	8	19	-/24-/24	2,3	15	35
K0338.1141084	K0338.1241084	K0338.1341084	K0338.1441084	traffic red RAL 3020	10	M20x1,5	33	74	28	12	25	10	22	-/30-/30	2,8	15	34
K0338.1141284	K0338.1241284	K0338.1341284	K0338.1441284	traffic red RAL 3020	12	M20x1,5	33	78	28	14	25	12	22	-/30-/30	2,8	15	39
K0338.1151684	K0338.1251684	K0338.1351684	K0338.1451684	traffic red RAL 3020	16	M24x2	40	96	32	18	28	16	27	-/36-/36	3,2	20	46

## Indexing plungers steel or stainless steel



## KIPP Indexing plungers, stainless steel A4, indexing pin hardened, nickel-plated

Order No. Form A	Order No. Form B	Order No. Form C	Order No. Form D	Component colour	D	D1	D2	L	L1	L2	L3	Travel S	SW1	SW2	Fx30°	Spring force initial pressure F1 approx. N	Spring force final pressure F2 approx. N
K0338.61903	K0338.62903	K0338.63903	K0338.64903	black grey RAL 7021	3	M6x0,75	14	31,5	12	5	10	3,5	8	-/10-/10	0,8	3	6,5
K0338.61004	K0338.62004	K0338.63004	K0338.64004	black grey RAL 7021	4	M8x1	18	38,5	15	6	13	4	10	-/13-/13	1	7	15,5
K0338.61105	K0338.62105	K0338.63105	K0338.64105	black grey RAL 7021	5	M10x1	21	43,5	17	7	15	5	13	-/17-/17	1,3	4	12,5
K0338.61206	K0338.62206	K0338.63206	K0338.64206	black grey RAL 7021	6	M12x1,5	25	51,7	20	8	17	6	14	-/19-/19	1,8	7	14,5
K0338.61308	K0338.62308	K0338.63308	K0338.64308	black grey RAL 7021	8	M16x1,5	33	68	26	10	23	8	19	-/24-/24	2,3	15	35
K0338.61410	K0338.62410	K0338.63410	K0338.64410	black grey RAL 7021	10	M20x1,5	33	74	28	12	25	10	22	-/30-/30	2,8	15	30
K0338.61412	K0338.62412	K0338.63412	K0338.64412	black grey RAL 7021	12	M20x1,5	33	78	28	14	25	12	22	-/30-/30	2,8	15	39
K0338.61516	K0338.62516	K0338.63516	K0338.64516	black grey RAL 7021	16	M24x2	40	96	32	18	28	16	27	-/36-/36	3,2	20	40
K0338.6190384	K0338.6290384	K0338.6390384	K0338.6490384	traffic red RAL 3020	3	M6x0,75	14	31,5	12	5	10	3,5	8	-/10-/10	0,8	3	6,5
K0338.6100484	K0338.6200484	K0338.6300484	K0338.6400484	traffic red RAL 3020	4	M8x1	18	38,5	15	6	13	4	10	-/13-/13	1	7	15,5
K0338.6110584	K0338.6210584	K0338.6310584	K0338.6410584	traffic red RAL 3020	5	M10x1	21	43,5	17	7	15	5	13	-/17-/17	1,3	4	12,5
K0338.6120684	K0338.6220684	K0338.6320684	K0338.6420684	traffic red RAL 3020	6	M12x1,5	25	51,7	20	8	17	6	14	-/19-/19	1,8	7	14,5
K0338.6130884	K0338.6230884	K0338.6330884	K0338.6430884	traffic red RAL 3020	8	M16x1,5	33	68	26	10	23	8	19	-/24-/24	2,3	15	35
K0338.6141084	K0338.6241084	K0338.6341084	K0338.6441084	traffic red RAL 3020	10	M20x1,5	33	74	28	12	25	10	22	-/30-/30	2,8	15	30
K0338.6141284	K0338.6241284	K0338.6341284	K0338.6441284	traffic red RAL 3020	12	M20x1,5	33	78	28	14	25	12	22	-/30-/30	2,8	15	39
K0338.6151684	K0338.6251684	K0338.6351684	K0338.6451684	traffic red RAL 3020	16	M24x2	40	96	32	18	28	16	27	-/36-/36	3,2	20	40

## KIPP Indexing plungers, stainless steel A4, indexing pin hardened, bright

Order No. Form A	Order No. Form B	Order No. Form C	Order No. Form D	Component colour	D	D1	D2	L	L1	L2	L3	Travel S	SW1	SW2	Fx30°	Spring force initial pressure F1 approx. N	Spring force final pressure F2 approx. N
K0338.71903	K0338.72903	K0338.73903	K0338.74903	black grey RAL 7021	3	M6x0,75	14	31,5	12	5	10	3,5	8	-/10-/10	0,8	3	6,5
K0338.71004	K0338.72004	K0338.73004	K0338.74004	black grey RAL 7021	4	M8x1	18	38,5	15	6	13	4	10	-/13-/13	1	7	15,5
K0338.71105	K0338.72105	K0338.73105	K0338.74105	black grey RAL 7021	5	M10x1	21	43,5	17	7	15	5	13	-/17-/17	1,3	4	12,5
K0338.71206	K0338.72206	K0338.73206	K0338.74206	black grey RAL 7021	6	M12x1,5	25	51,7	20	8	17	6	14	-/19-/19	1,8	7	14,5
K0338.71308	K0338.72308	K0338.73308	K0338.74308	black grey RAL 7021	8	M16x1,5	33	68	26	10	23	8	19	-/24-/24	2,3	15	35
K0338.71410	K0338.72410	K0338.73410	K0338.74410	black grey RAL 7021	10	M20x1,5	33	74	28	12	25	10	22	-/30-/30	2,8	15	30
K0338.71412	K0338.72412	K0338.73412	K0338.74412	black grey RAL 7021	12	M20x1,5	33	78	28	14	25	12	22	-/30-/30	2,8	15	39
K0338.71516	K0338.72516	K0338.73516	K0338.74516	black grey RAL 7021	16	M24x2	40	96	32	18	28	16	27	-/36-/36	3,2	20	40
K0338.7190384	K0338.7290384	K0338.7390384	K0338.7490384	traffic red RAL 3020	3	M6x0,75	14	31,5	12	5	10	3,5	8	-/10-/10	0,8	3	6,5
K0338.7100484	K0338.7200484	K0338.7300484	K0338.7400484	traffic red RAL 3020	4	M8x1	18	38,5	15	6	13	4	10	-/13-/13	1	7	15,5
K0338.7110584	K0338.7210584	K0338.7310584	K0338.7410584	traffic red RAL 3020	5	M10x1	21	43,5	17	7	15	5	13	-/17-/17	1,3	4	12,5
K0338.7120684	K0338.7220684	K0338.7320684	K0338.7420684	traffic red RAL 3020	6	M12x1,5	25	51,7	20	8	17	6	14	-/19-/19	1,8	7	14,5
K0338.7130884	K0338.7230884	K0338.7330884	K0338.7430884	traffic red RAL 3020	8	M16x1,5	33	68	26	10	23	8	19	-/24-/24	2,3	15	35
K0338.7141084	K0338.7241084	K0338.7341084	K0338.7441084	traffic red RAL 3020	10	M20x1,5	33	74	28	12	25	10	22	-/30-/30	2,8	15	30
K0338.7141284	K0338.7241284	K0338.7341284	K0338.7441284	traffic red RAL 3020	12	M20x1,5	33	78	28	14	25	12	22	-/30-/30	2,8	15	39
K0338.7151684	K0338.7251684	K0338.7351684	K0338.7451684	traffic red RAL 3020	16	M24x2	40	96	32	18	28	16	27	-/36-/36	3,2	20	40