

## Spring plungers

with slot and thrust pin, stainless steel

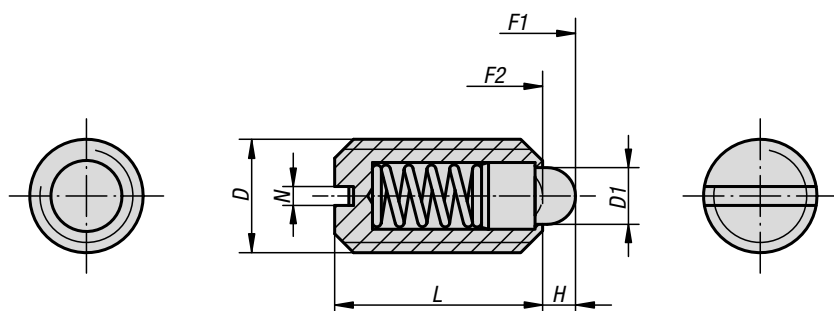

**Material:**  
Sleeve 1.4305.  
Thrust pin 1.4034.  
Spring 1.4310.

**Version:**  
Bright.  
Thrust pin hardened.

**Sample order:**  
K0314.10

### KIPP Spring plungers with slot and thrust pin, standard spring force

Order No.	D	D1	H	L	N	Spring force initial pressure F1 approx. N	Spring force final pressure F2 approx. N
K0314.04	M4	1,8	1,5	9	0,6	6	20
K0314.05	M5	2,4	2	12	0,8	6	20
K0314.06	M6	2,7	2	14	1	7	20
K0314.08	M8	4	2	16	1,2	15	30
K0314.10	M10	4,5	2,5	19	1,6	20	35
K0314.12	M12	6	3,5	22	2	30	55
K0314.16	M16	8,5	4,5	24	2,5	45	100
K0314.20	M20	10	6,5	30	2,5	60	120

### KIPP Spring plungers with slot and thrust pin, light spring force

Order No.	D	D1	H	L	N	Spring force initial pressure F1 approx. N	Spring force final pressure F2 approx. N
K0314.104	M4	1,8	1,5	9	0,6	3	10
K0314.105	M5	2,4	2	12	0,8	3	10
K0314.106	M6	2,7	2	14	1	4	10
K0314.108	M8	4	2	16	1,2	7	15
K0314.110	M10	4,5	2,5	19	1,6	9	16
K0314.112	M12	6	3,5	22	2	14	26
K0314.116	M16	8,5	4,5	24	2,5	22	50
K0314.120	M20	10	6,5	30	2,5	30	60

### KIPP Spring plungers with slot and thrust pin, reinforced spring force

Order No.	D	D1	H	L	N	Spring force initial pressure F1 approx. N	Spring force final pressure F2 approx. N
K0314.205	M5	2,4	2	12	0,8	9	25
K0314.206	M6	2,7	2	14	1	11	25
K0314.208	M8	4	2	16	1,2	22	43
K0314.210	M10	4,5	2,5	19	1,6	20	54
K0314.212	M12	6	3,5	22	2	36	94
K0314.216	M16	8,5	4,5	24	2,5	60	110