

Fixture feet

with internal thread



Material:

Body high carbon steel.

Version:

Body tempered and black oxidised.
Contact faces case-hardened.

Sample order:

K0301.106X20

Note:

Fixture feet with internal thread are used as supports for fixtures or rough or machined workpieces. They can also be used as stops or thrust pads in fixtures and toolmaking.

Drawing reference:

Form A: hardened face

Form B: face hardened and ground

Form C: hardened spherical surface

Form D: tempered serrated surface

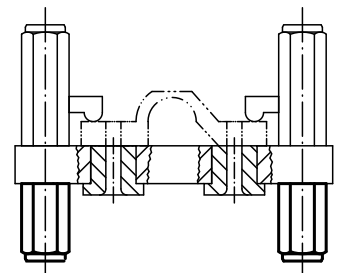
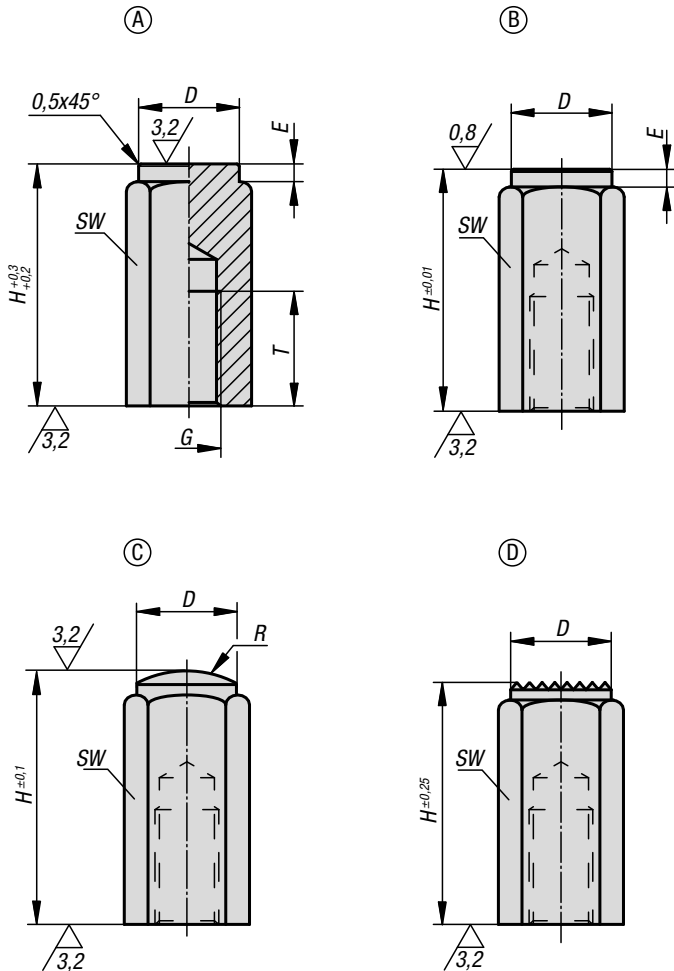

KIPP Fixture feet with internal thread

Order No. Form A	Order No. Form B	Order No. Form C	Order No. Form D	D	E	G	H	R	T	SW
K0301.106X20	K0301.206X20	K0301.306X20	K0301.406X20	9,5	2/2/-/-	M6	20	-/-/15/-	12	10
K0301.106X40	K0301.206X40	K0301.306X40	K0301.406X40	9,5	2/2/-/-	M6	40	-/-/15/-	12	10
K0301.110X32	K0301.210X32	K0301.310X32	K0301.410X32	16,5	3/3/-/-	M10	32	-/-/30/-	18	17
K0301.110X63	K0301.210X63	K0301.310X63	K0301.410X63	16,5	3/3/-/-	M10	63	-/-/30/-	18	17
K0301.112X32	K0301.212X32	K0301.312X32	K0301.412X32	18,5	3/3/-/-	M12	32	-/-/35/-	18	19
K0301.112X63	K0301.212X63	K0301.312X63	K0301.412X63	18,5	3/3/-/-	M12	63	-/-/35/-	18	19
K0301.116X50	K0301.216X50	K0301.316X50	K0301.416X50	23	4/4/-/-	M16	50	-/-/40/-	24	24
K0301.116X100	K0301.216X100	K0301.316X100	K0301.416X100	23	4/4/-/-	M16	100	-/-/40/-	24	24